

PRO-LINE **PRO-FUSION SC4X4**

1:10 4WD SHORT COURSE TRUCK
READY-TO-BUILD KIT



INSTRUCTION MANUAL

PRO-LINE PRO-FUSION SC 4x4

**1:10 4WD SHORT COURSE TRUCK
READY-TO-BUILD KIT**

Thank you for purchasing Pro-Line's PRO-Fusion SC 4x4! For Over 35 years, Pro-Line has designed and manufactured the best RC products in the world. This 1:10 scale 4x4 SC truck has been

developed from the ground up for extreme performance, durability, versatility, and most importantly, fun! Thank you for choosing the PRO-Fusion SC 4x4 and joining Team Pro-Line in making history!

This assembly manual contains instructions for building your new PRO-Fusion SC 4x4. Please take your time building the kit according to the instructions and become familiar with the steps.

Pro-Line is continually improving our products; consequently, actual parts included in the PRO-Fusion SC 4x4 kit may appear slightly different than the images that appear in the manual.

Equipment Needed

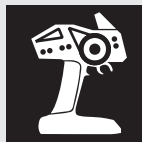

RADIO

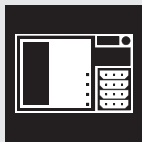

RECEIVER



SERVO
(HORNS INCLUDED)

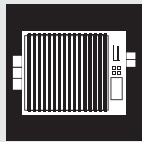

ESC

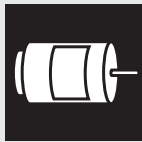

MOTOR
550 SIZE OR 1:8 SIZE

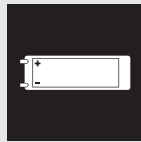

LIPO BATTERY
2S, 3S, OR 4S

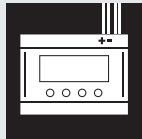

CHARGER



RC BODY & PAINT
SHORT COURSE

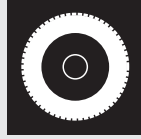

TIRES & WHEELS
SC OR 2.8" MT - 17MM HEX

Recommended Tools

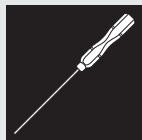

HEX DRIVERS
1.5MM, 2MM, 2.5MM



NUT DRIVERS
5.5MM AND 7MM



SIDE CUTTERS



SERVO TAPE



THREAD LOCK

INCLUDED TOOLS



WHEEL WRENCH
17MM

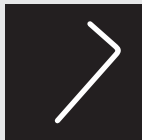

HEX KEY
3MM

Precautions

To prevent serious personal injury and/or property damage, operate all remotely controlled models in a responsible manner as described herein.

Choose the right place to operate your RC model:

- Do not run RC vehicles on public streets or highways
- Do not run RC vehicles near people or animals
- Do not run RC vehicles where noise can disturb others

Inspect your vehicle before operation:

- Make sure that all screws and nuts are properly tightened
- Always use fresh batteries in your radio
- Always test the throttle and steering before setting the vehicle on the ground

After operation of your RC vehicle:

- To prevent a runaway, turn off the vehicle first, then the radio
- Replace any battery that has puffed, has been dented, or has frayed wiring
- Keep your vehicle clean and free of excess dirt and debris
- Immediately after use, do not touch any equipment on the vehicle such as the motor or ESC, as they could generate high temperatures and cause burns
- Store your vehicle and battery in a place where a fire cannot spread

WARNING!

This is NOT a toy and is NOT suitable for children under 14 years of age. This RC vehicle contains many small parts which are potential choking hazards. Keep all components out of reach of small children.

HEALTH WARNING!

This product contains chemicals known to the State of California to cause cancer, birth defects, or other reproductive harm. This RC vehicle is a high performance radio controlled model and can cause harm or personal injury. All liquids contained in this RC vehicle are not to be swallowed. Never touch rotating parts as this can cause injury.

Help & Information

Installation manuals and videos can be found on our website at www.prolineracing.com/pro-fusion-sc4x4.



If you need any technical assistance or have questions about your PRO-Fusion, please submit a Support Ticket at support.prolineracing.com.

HARDWARE USED
(ACTUAL SIZE)

1

BAG A

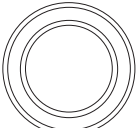
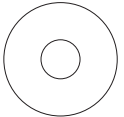
Differential Assembly - Build 3x

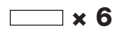
-  **x 3**
18 x 12 x 4 Bearings
-  **x 6**
Large Diff Shim
-  **x 6**
8 x 1.5 O-Ring
-  **x 6**
4.7 x 0.5 O-Ring
-  **x 6**
Diff Drive Pin



INSTALL DRIVE PIN

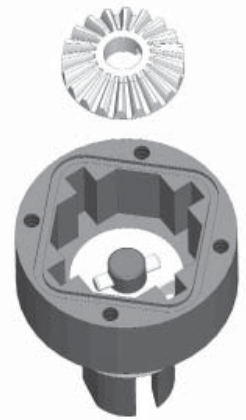
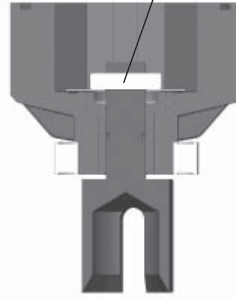

2

BAG A

Differential Assembly

Build 3x

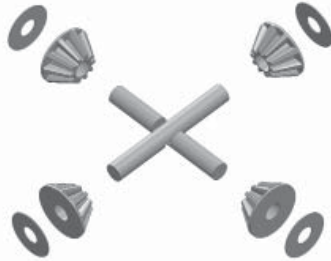

FOR CENTER DIFF

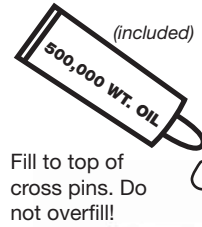

FRONT & REAR DIFFS

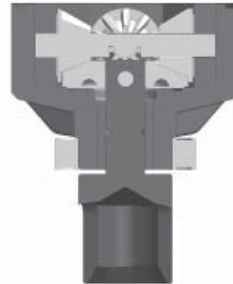

Build 3x





HARDWARE USED
(ACTUAL SIZE)

3

BAG A

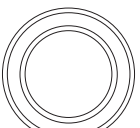
Differential Assembly

-  **x 3**
18 x 12 x 4 Bearings
-  **x 12**
M2.5 x 10 BHCS
-  **x 3**
Diff Seal O-Ring

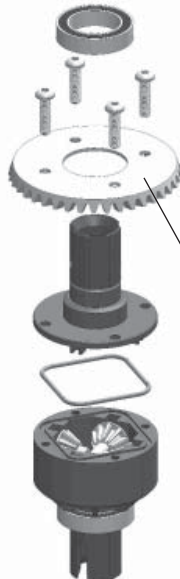

FOR CENTER DIFF
Use 44T MOD1 spur gear

Build 2x

FOR FRONT & REAR DIFFS
Use 40T MOD1 Straight Bevel Gear



HARDWARE USED
(ACTUAL SIZE)

4

 x 5
M4 x 12 FHCS

 x 3
M3 x 10 FHCS

 x 3
M3 Locknut

CHASSIS BAG + BAG A

Center Diff Mount, Battery Foam & Chassis Braces

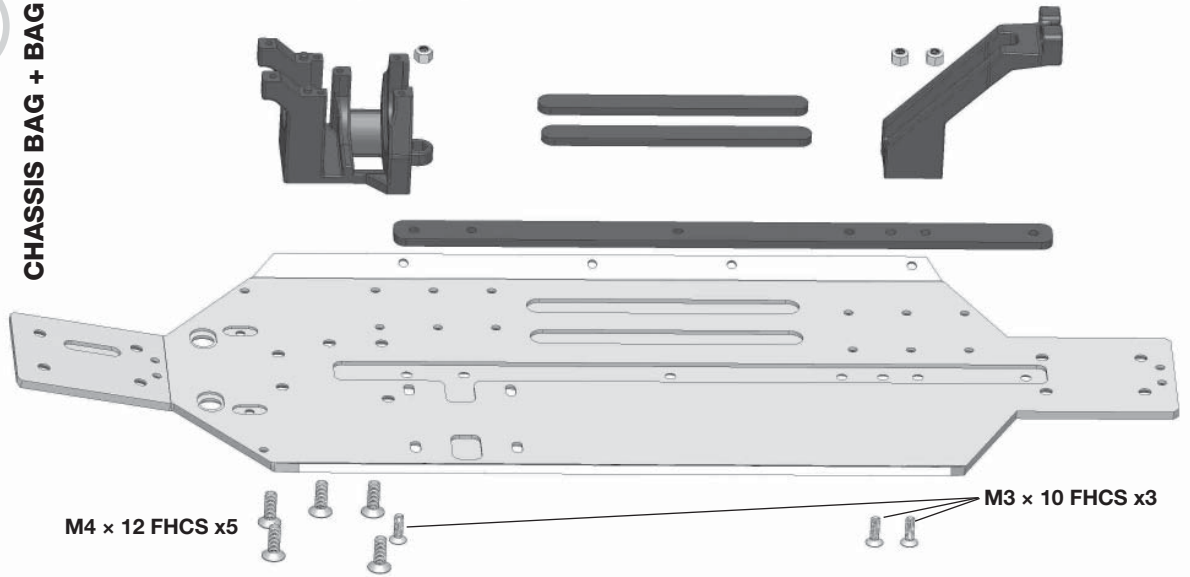

HARDWARE USED
(ACTUAL SIZE)

5

 x 2
M3 x 10 FHCS

 x 4
M3 x 25 SHCS

CHASSIS BAG + BAG A

Center Diff & Steering Posts

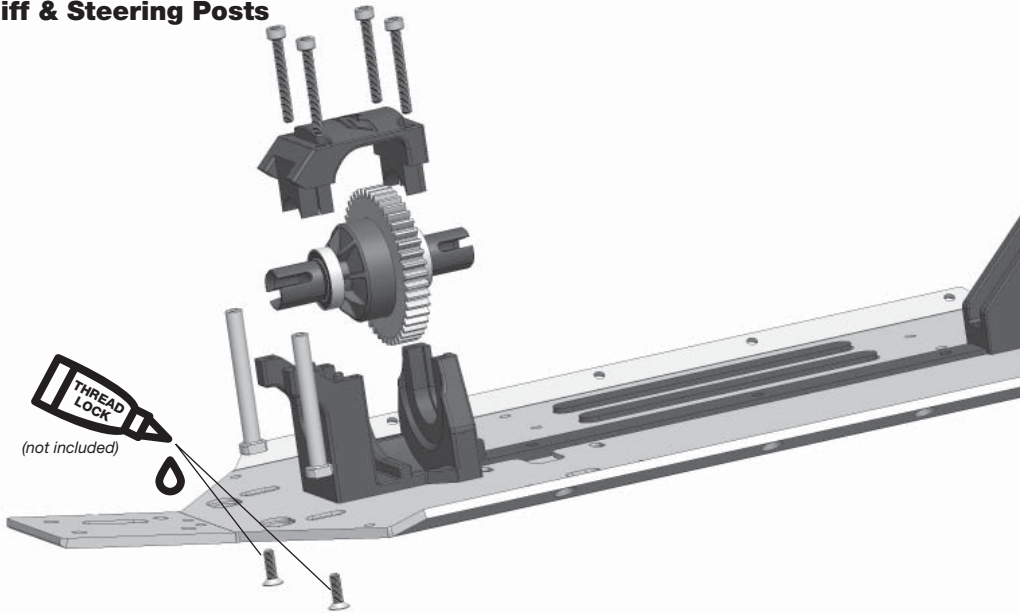

HARDWARE USED
(ACTUAL SIZE)

6

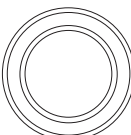
 x 2
18 x 12 x 4 Bearings

 x 1
Diff Gear Clip

BAG B

Front Diff Case Assembly

PRO TIP
Optional HD outdrive clip included for use with extreme power. May require snap ring pliers *(not included)* to install.

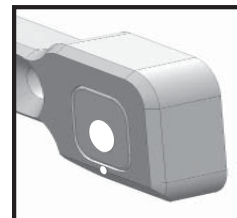
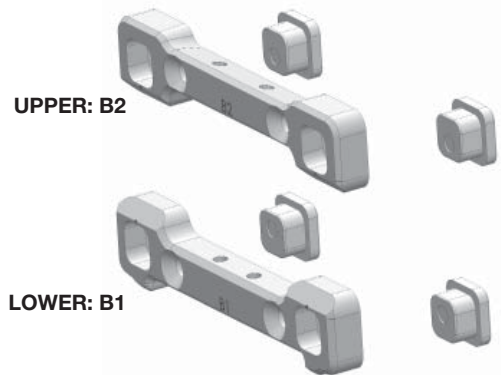
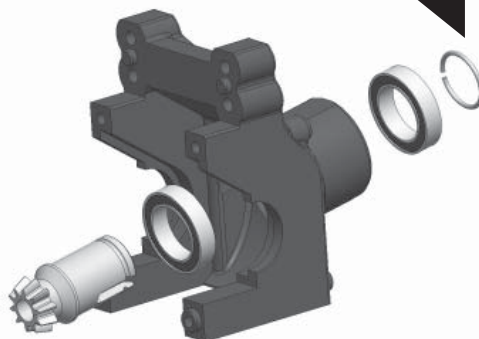

NOTE ORIENTATION
On all hinge pin inserts, align the large dot pointing towards the marking on the mount. This is the stock setting.

HARDWARE USED
(ACTUAL SIZE)

7

BAG B

Front Diff Case Assembly

 x 4
M3 x 14 FHCS

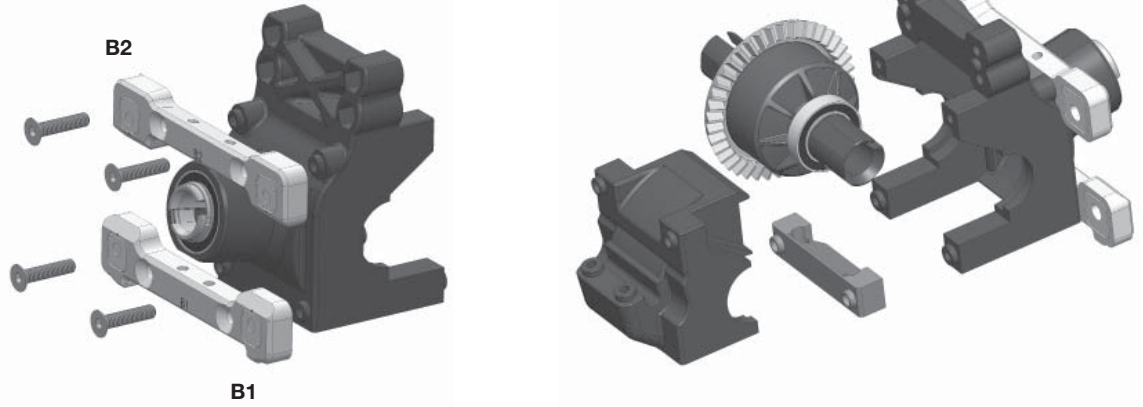

HARDWARE USED
(ACTUAL SIZE)

8

BAG B

Front Arms & Hinge Pins

 x 4
M3 x 20 FHCS

 x 4
1mm Shim

 x 4
2mm Shim

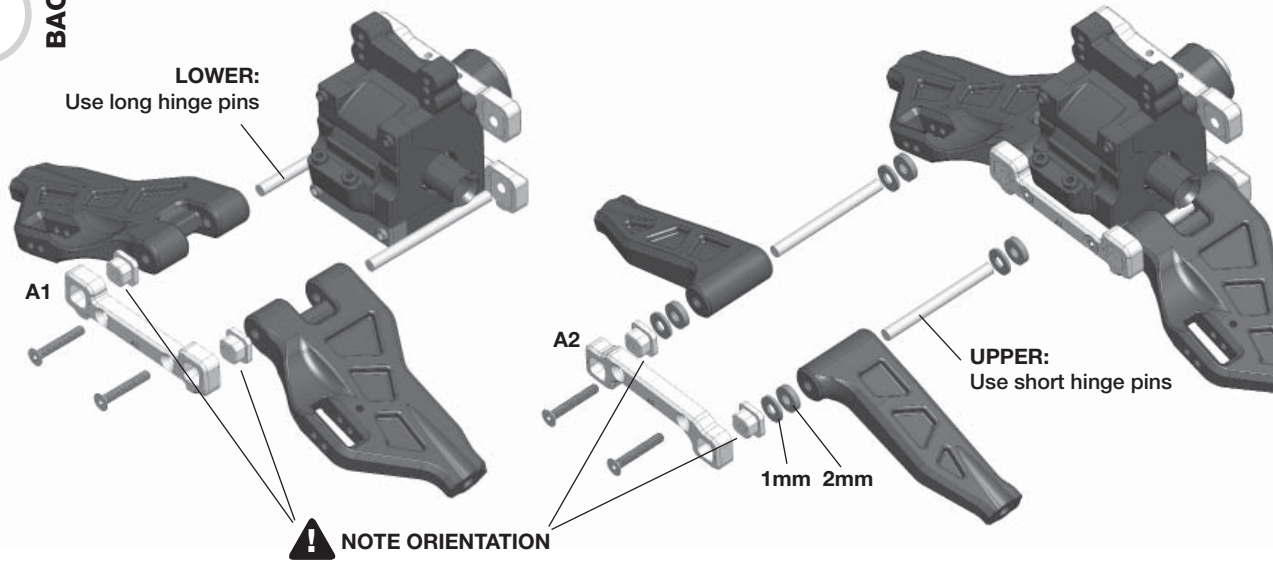

HARDWARE USED
(ACTUAL SIZE)

9

BAG C

Front Hub & Pivot Balls - Build L + R

 x 4
Pivot Ball Inserts

 x 4
Pivot Ball Set Screws

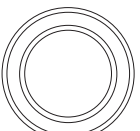
 x 2
18 x 12 x 4 Bearings

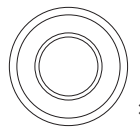
 x 2
16 x 8 x 5 Bearings

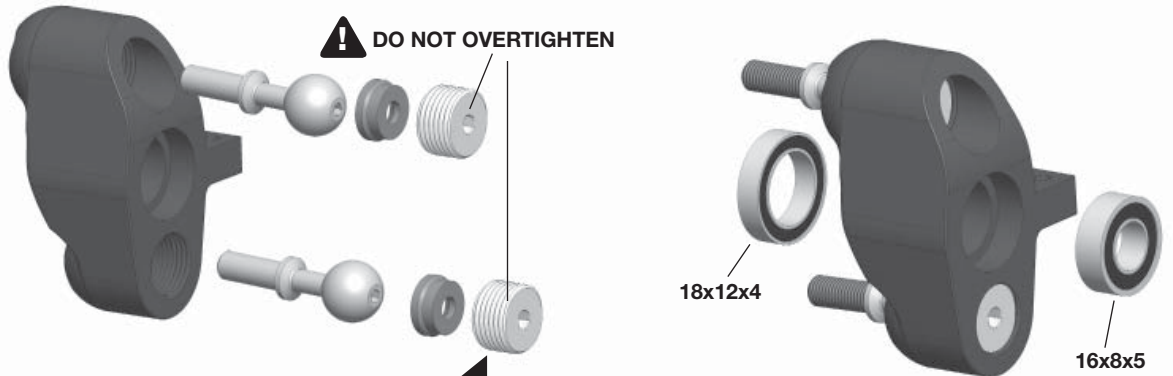

PRO TIP

Install using the included 3mm hex key included with the kit.

HARDWARE USED
(ACTUAL SIZE)

10

BAG C

Front Axle & Hub Assembly

 x 2
Drive Pin

 x 2
Drive Pin Cup

 x 2
M3 Set Screw

 x 2
M4 x 16 Modified Set Screw



HARDWARE USED
(ACTUAL SIZE)

11

BAG C

Pivot Balls to Front Arms

 x 6
0.75mm Shim

 **IMPORTANT**

Ensure driveshaft is seated into outdrive before screwing pivot balls to arms. Alternate tightening top and bottom pivot balls to ensure both are tightened evenly.

PRO TIP
Access the pivot ball through the set screw using a 2mm hex driver (not included).

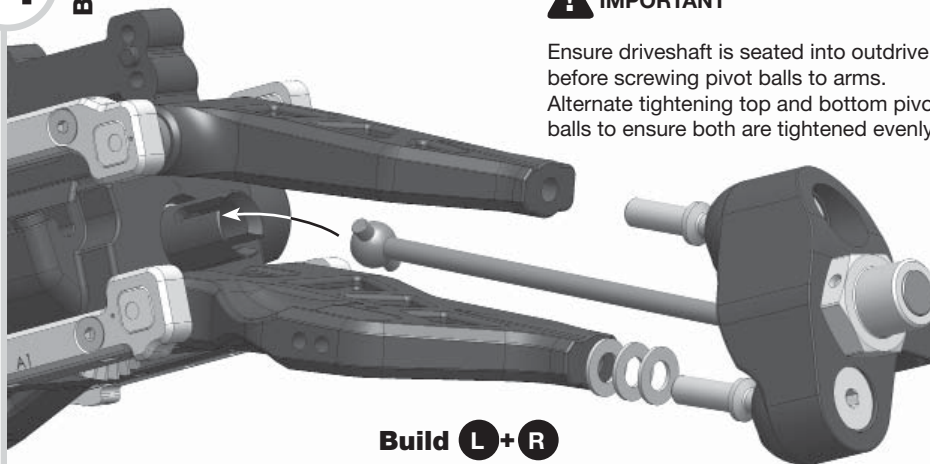

HARDWARE USED
(ACTUAL SIZE)

12

BAG C

Steering Plates & Shock Tower

 x 4
M3 x 10 SHCS

 x 4
M3 x 16 SHCS

 x 8
M3 Locknut

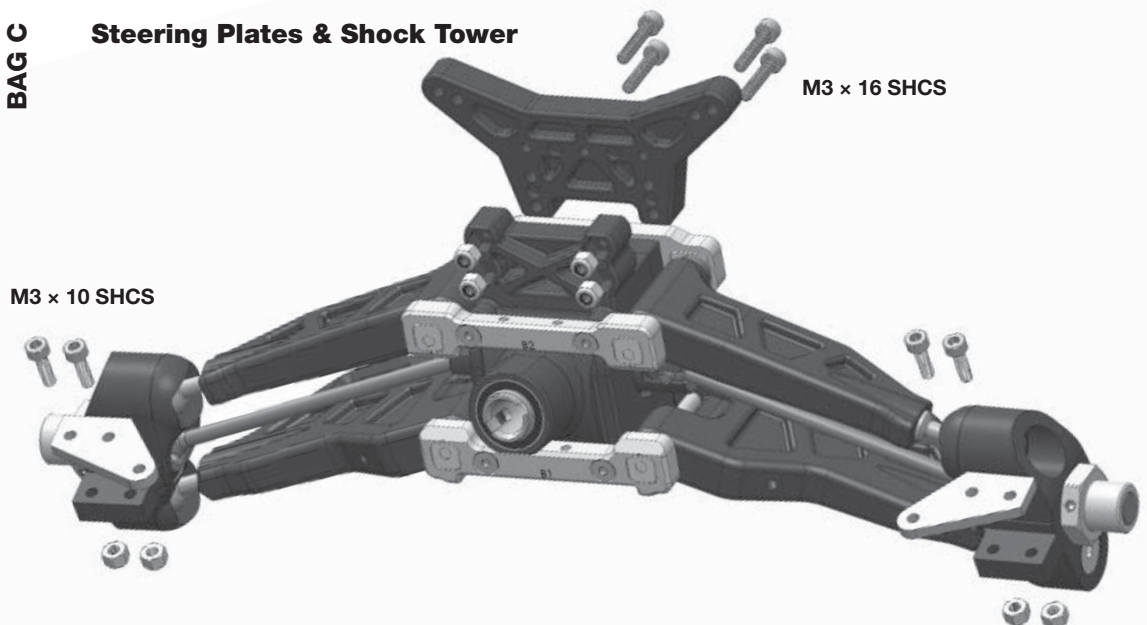

HARDWARE USED
(ACTUAL SIZE)

13

BAG D

Steering Rack

 x 4
11 x 5 x 4 Bearing

 x 2
M3 Locknut

 x 2
M3 x 22 SHCS

 x 2
Flanged Bearings

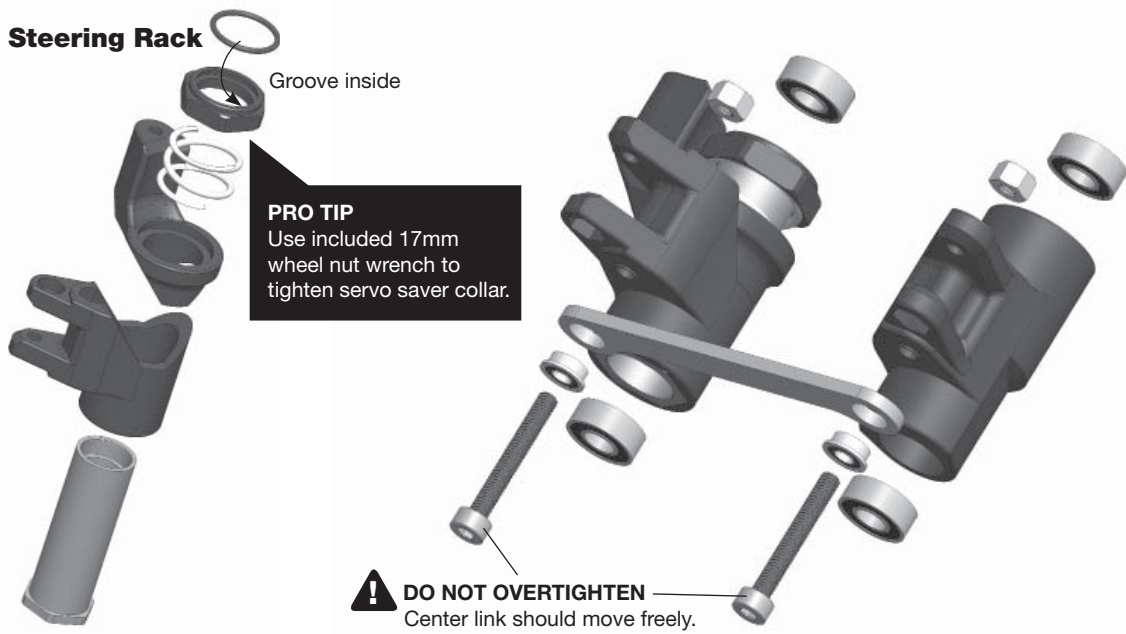

PRO TIP
Use included 17mm wheel nut wrench to tighten servo saver collar.

DO NOT OVERTIGHTEN
Center link should move freely.

HARDWARE USED
(ACTUAL SIZE)

14

BAG D

Steering Rack to Chassis

 x 2
M3 x 5 FHCS

PRO TIP
These chassis plugs can be removed for easy access to the steering rack screws without removing the top deck.

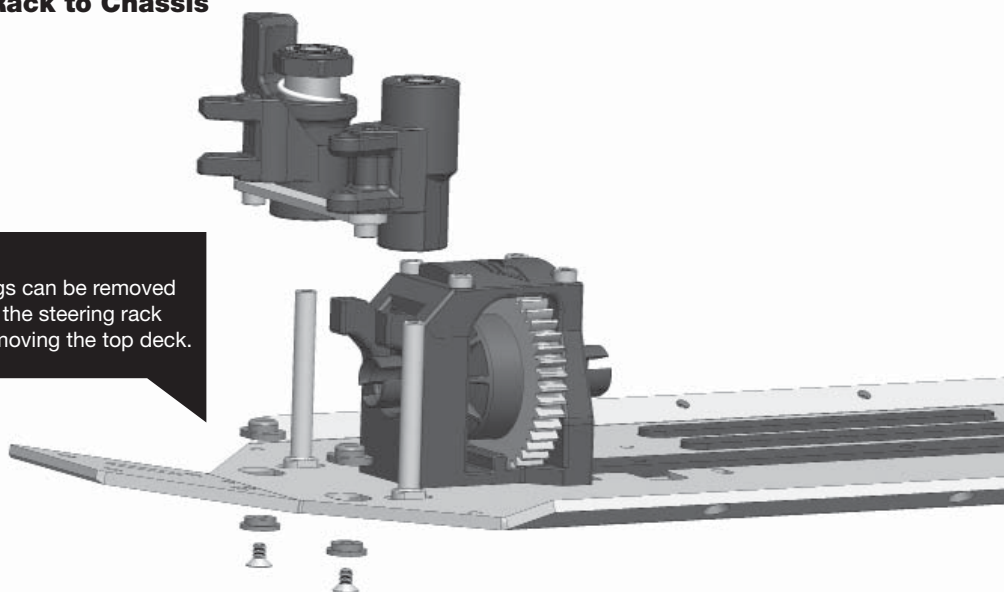

HARDWARE USED
(ACTUAL SIZE)

15

BAG D

Front Clip to Chassis

 x 2
M3 x 10 FHCS

IMPORTANT

Ensure short driveshaft is seated into both front diff and center diff outrdrives before attaching front clip to chassis.

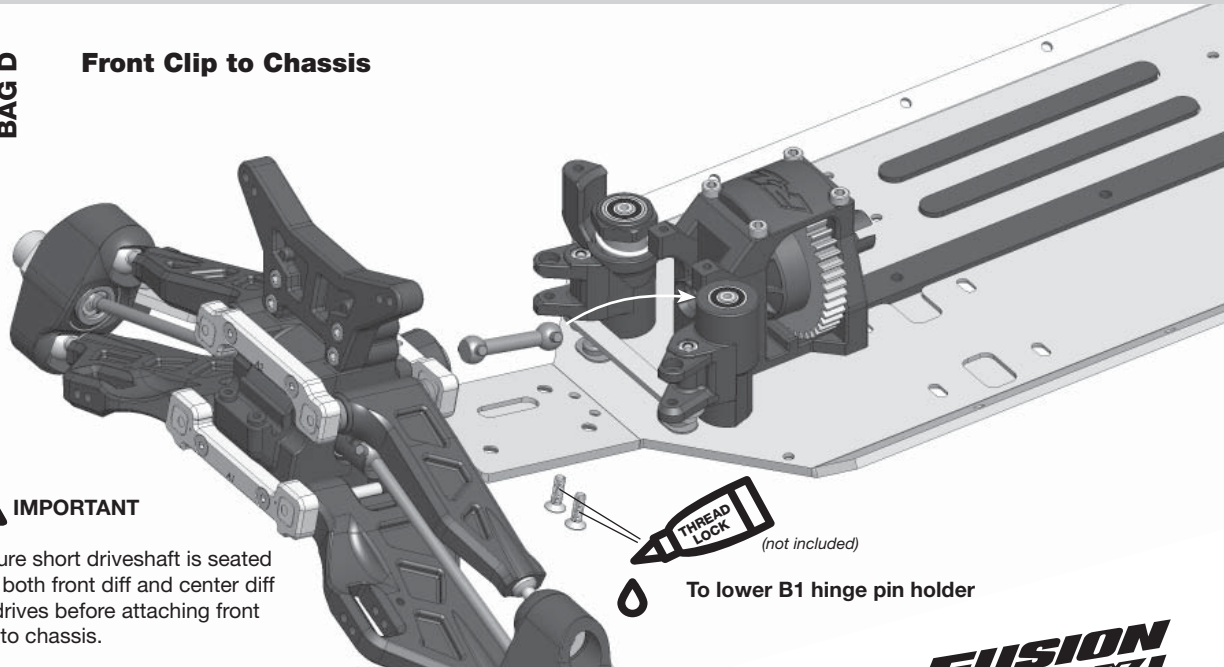

THREAD LOCK
(not included)
To lower B1 hinge pin holder

HARDWARE USED
(ACTUAL SIZE)

16

BAG D

Install Top Plate

 x 6
M3 x 10 SHCS

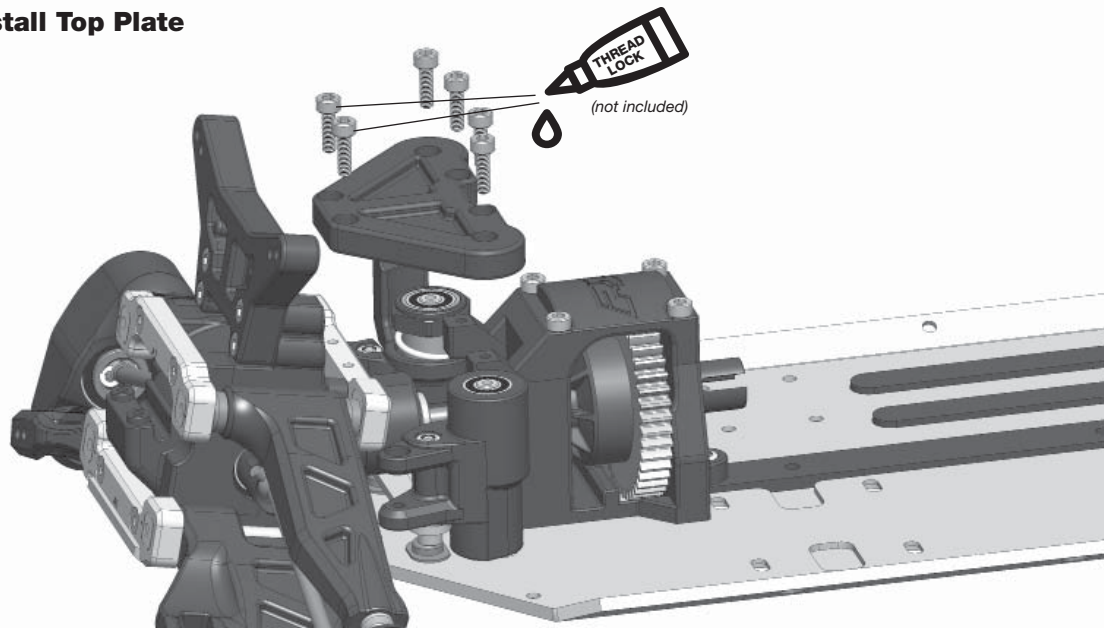

HARDWARE USED
(ACTUAL SIZE)

17

BAG D

Steering Turnbuckle Assembly - Build 2x

 x 4
Long Rod End

 x 4
Steering Pivot Balls

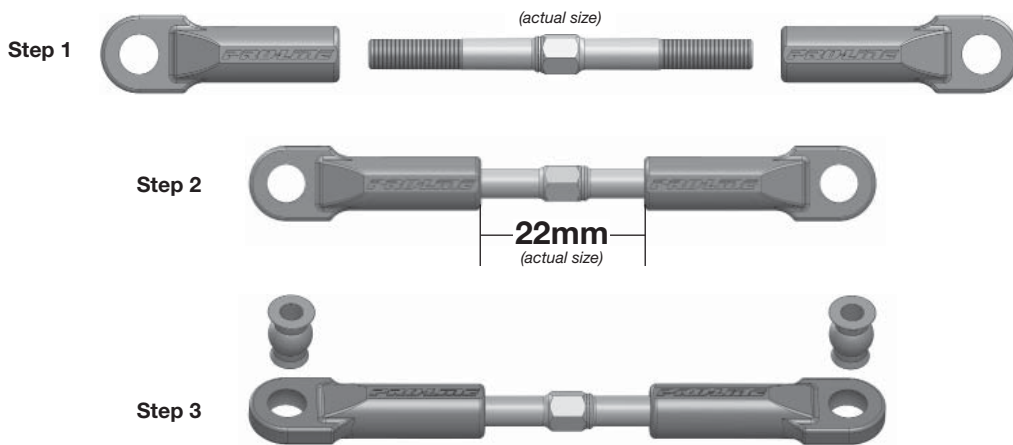

HARDWARE USED
(ACTUAL SIZE)

18

BAG D

Install Steering Turnbuckles

 x 4
M3 x 16 SHCS

 x 4
M3 Locknut

Build L + R

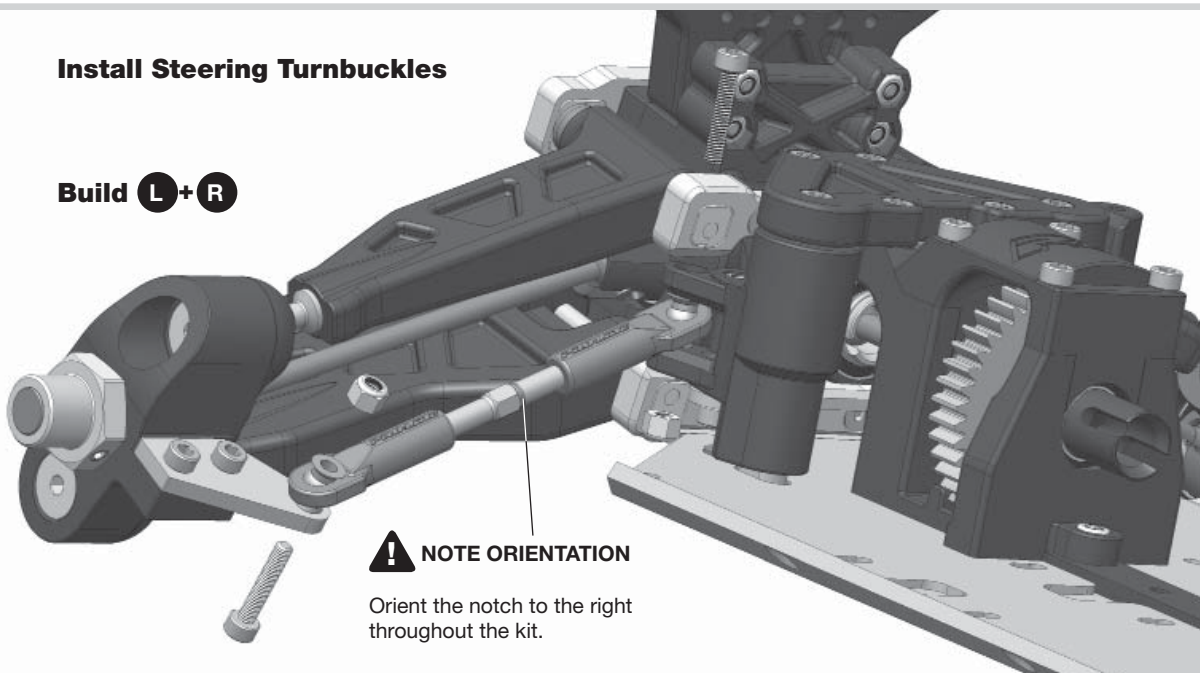

HARDWARE USED
(ACTUAL SIZE)

19

BAG E

Rear Diff Case Assembly & Rear Arms

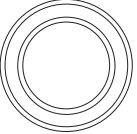
 **x 2**
18 x 12 x 4 Bearings

 **x 1**
Diff Gear Clip

 **x 2**
M3 x 14 FHCS

 **x 2**
M3 x 20 FHCS

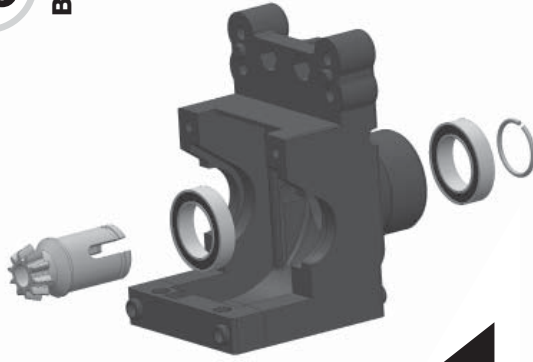

PRO TIP
Optional HD outride clip included for use with extreme power. May require snap ring pliers (*not included*) to install.

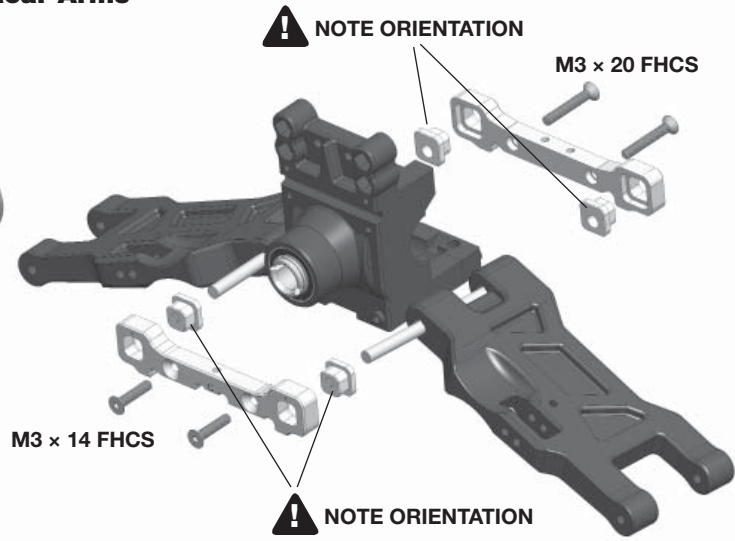

NOTE ORIENTATION

M3 x 20 FHCS

M3 x 14 FHCS

NOTE ORIENTATION

HARDWARE USED
(ACTUAL SIZE)

20

BAG E

Rear Diff Case Assembly & Rear Clip to Chassis

 **x 2**
M3 x 16 SHCS

 **x 2**
M3 x 10 SHCS

 **x 2**
M3 Locknut

 **x 3**
M3 x 10 FHCS

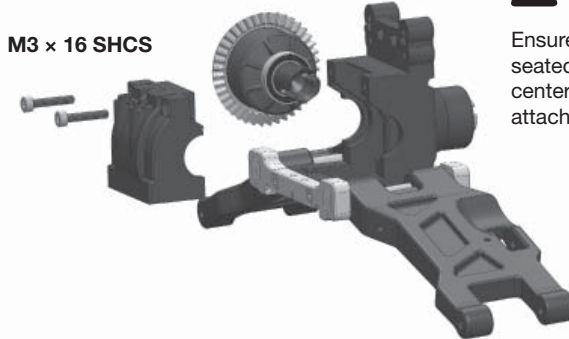

M3 x 16 SHCS

IMPORTANT

Ensure rear driveshaft is seated into both rear diff and center diff outrives before attaching rear clip to chassis.

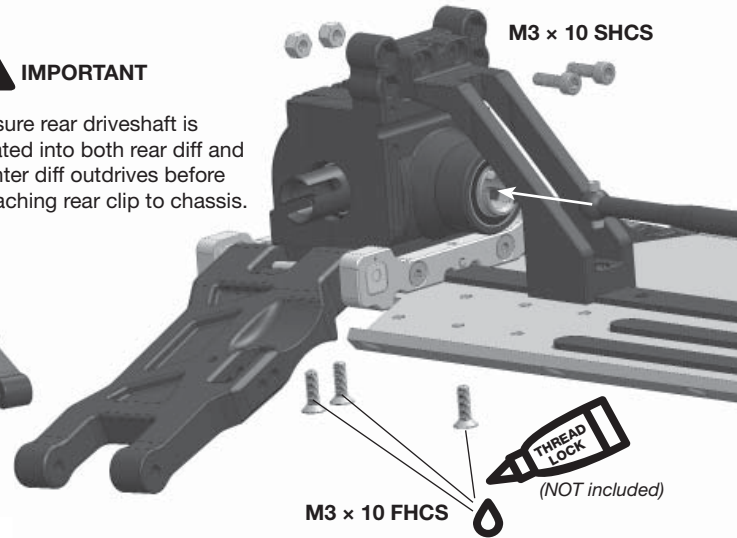

M3 x 10 SHCS

M3 x 10 FHCS



(NOT included)

HARDWARE USED
(ACTUAL SIZE)

21

BAG E

Rear Axle & Hub Assembly

 **x 2**
Drive Pin

 **x 2**
Drive Pin Cup

 **x 2**
M3 Set Screw

 **x 2**
M4 x 16 Modified Set Screw

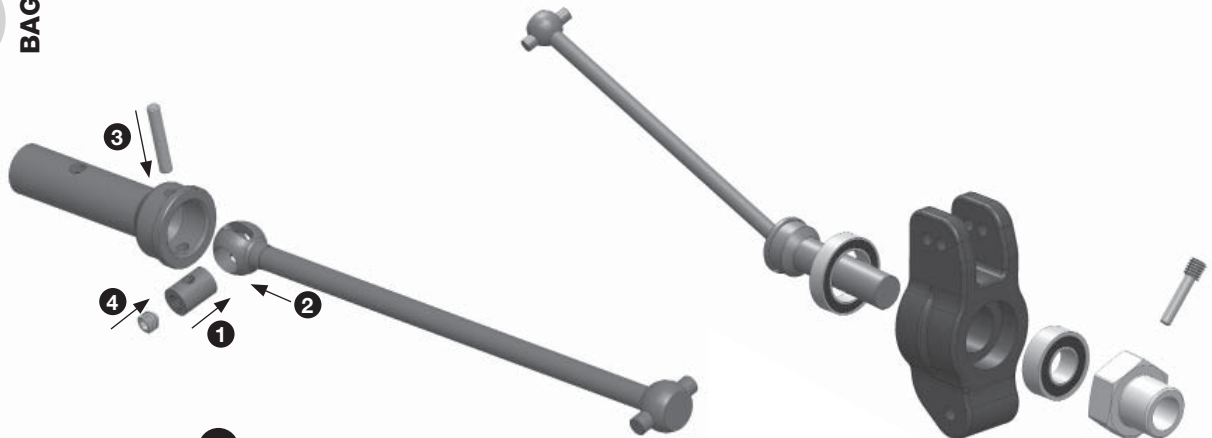

Build 2x

HARDWARE USED
(ACTUAL SIZE)

22

BAG E

 x 4
M3 x 16 SHCS

 x 6
M3 Locknut

 x 2
2mm Shim

 x 4
1mm Shim

Rear Hubs to Arms & Rear Shock Tower

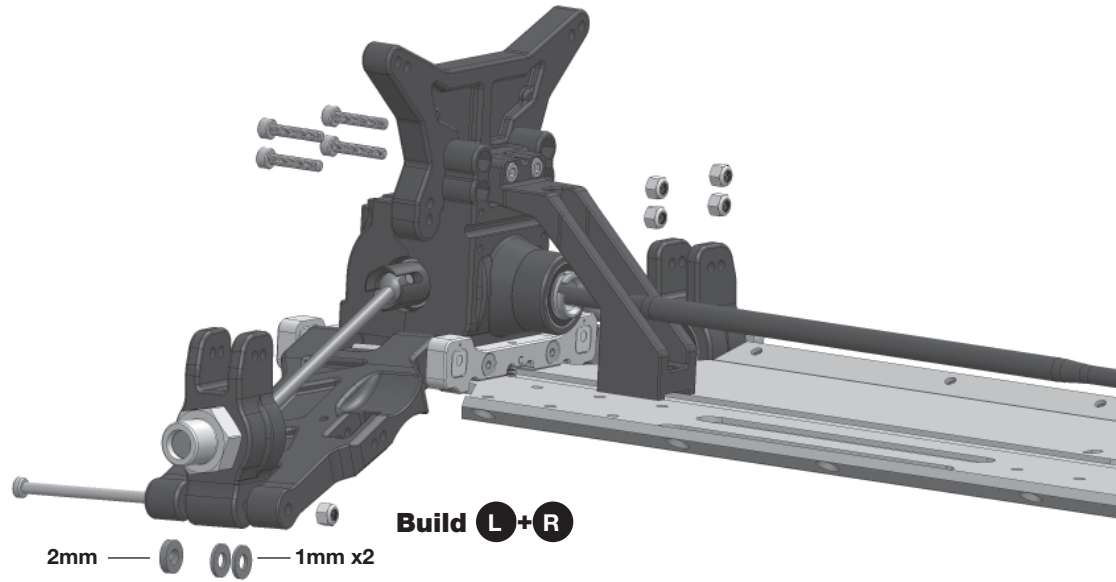

HARDWARE USED
(ACTUAL SIZE)

23

BAG E

Rear Turnbuckle Assembly - Build 2x

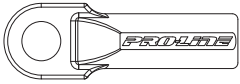
 x 4
Long Rod End

 x 4
Steering Pivot Balls

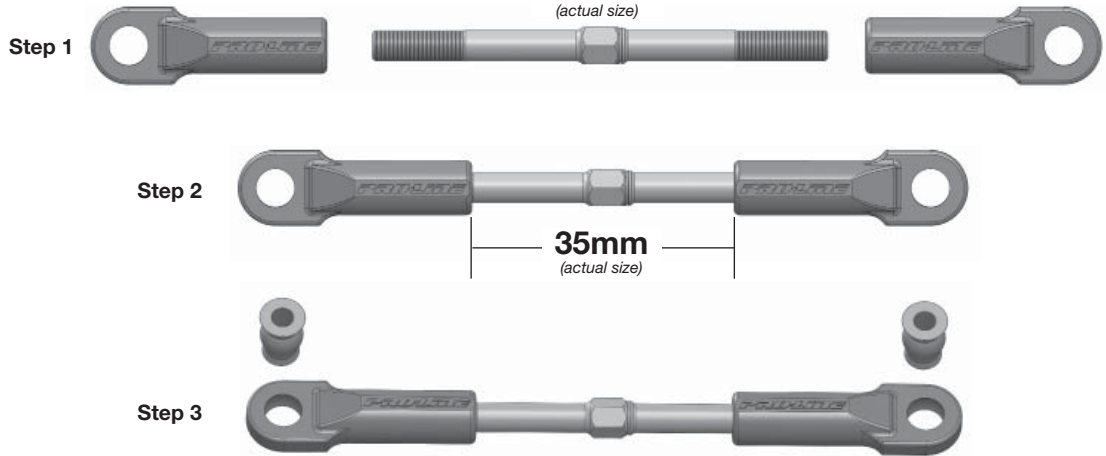

HARDWARE USED
(ACTUAL SIZE)

24

BAG E

Install Rear Turnbuckles

 x 4
M3 x 22 SHCS

 x 4
M3 Locknut

! IMPORTANT

Ensure driveshaft is seated into rear diff outdrive before installing turnbuckles.

Build L+R

! NOTE ORIENTATION

Orient the notch to the right throughout the kit.

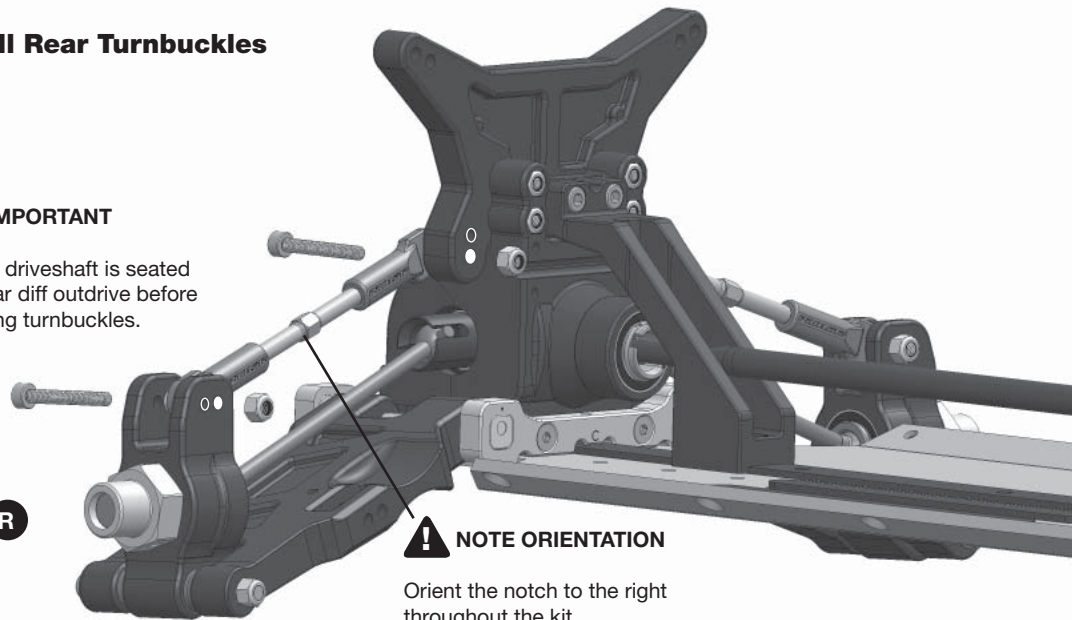

HARDWARE USED
(ACTUAL SIZE)

25

BAG F

Rear Sway Bar Assembly

 x 4
M3 x 3 Set Screw



FOR REAR SWAY BAR
Use 2.7mm bar (thinner of 2 bars)

38.5mm
(actual size)

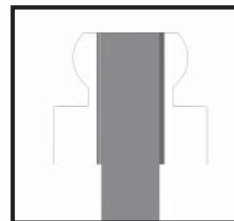

! IMPORTANT



Ensure the end of the sway bar is flush with the end of the pivot ball before securing it with set screw.

HARDWARE USED
(ACTUAL SIZE)

26

BAG F

Rear Sway Bar to Chassis

 x 4
M2.5 x 10 SHCS
 x 2
M3 x 4 Set Screw

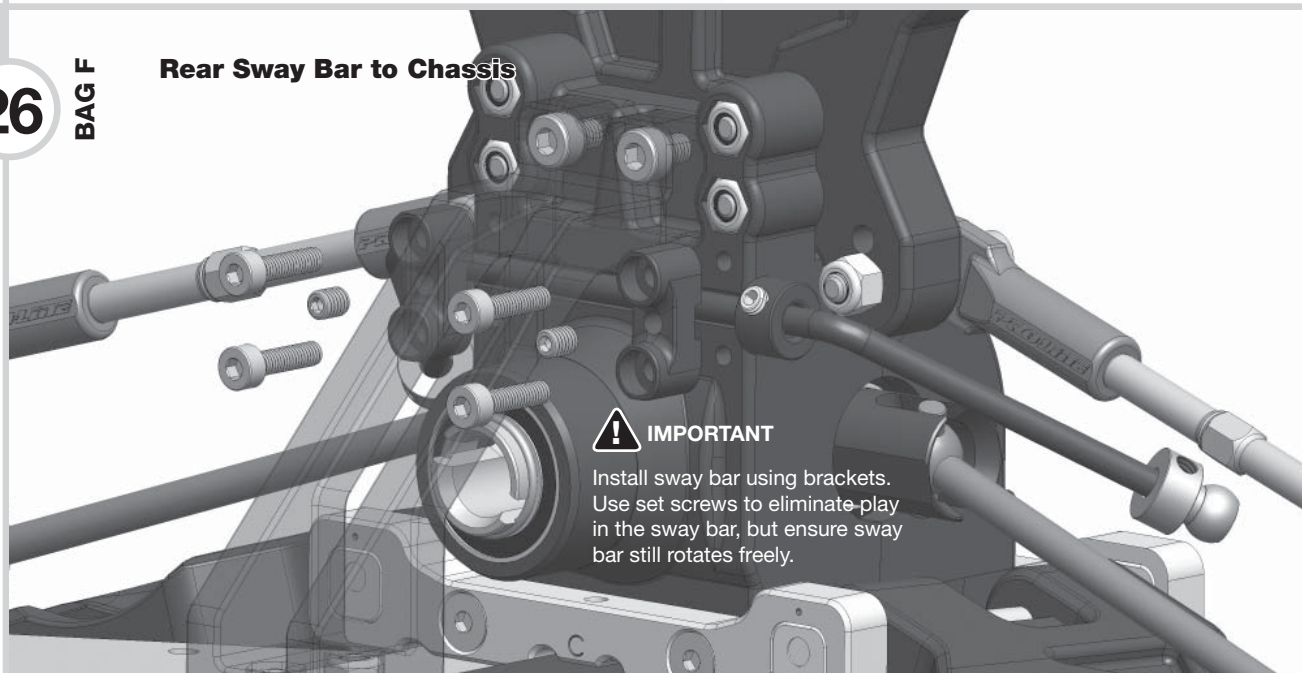

! IMPORTANT

Install sway bar using brackets. Use set screws to eliminate play in the sway bar, but ensure sway bar still rotates freely.

HARDWARE USED
(ACTUAL SIZE)

27

BAG F

Rear Sway Bar to Arms

 x 2
Sway Bar Ball Stud

 x 2
Long Sway Bar Link

Build L + R

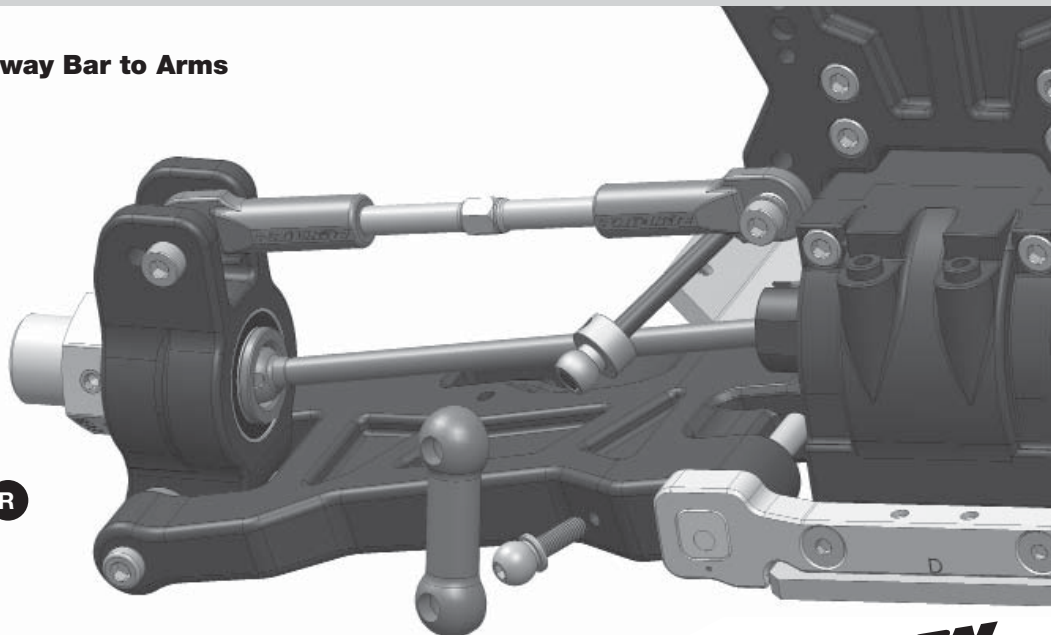

HARDWARE USED
(ACTUAL SIZE)

28

BAG F

Rear Bumper & Skid Plate Assembly

 x 4
M3 x 8 SHCS

 x 2
M4 x 22 SHCS

 x 2
M4 x 12 FHCS

 x 2
M3 x 12 SHCS

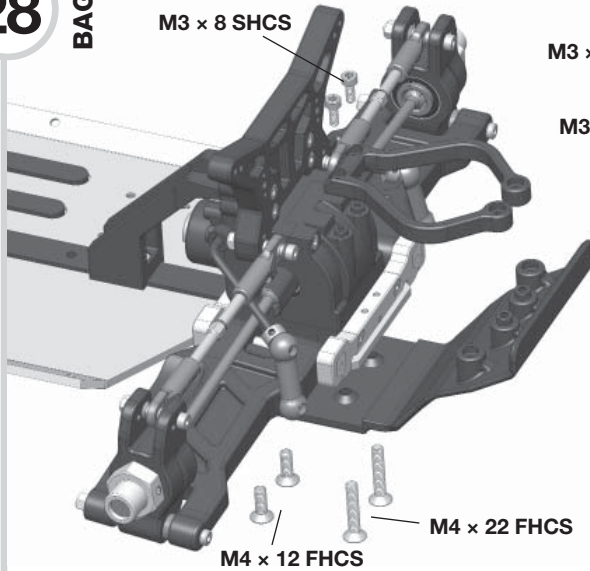

 x 2
M3 x 12 SHCS

 x 2
M3 x 8 SHCS

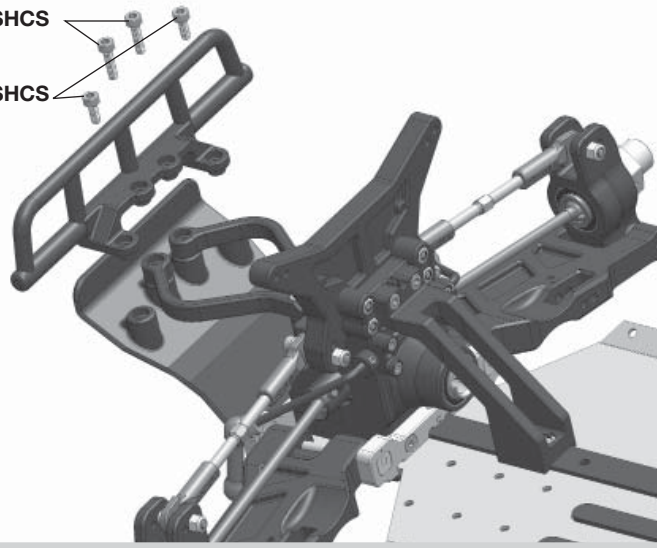

HARDWARE USED
(ACTUAL SIZE)

29

BAG F

Front Sway Bar Assembly

 x 4
M3 x 3 Set Screw

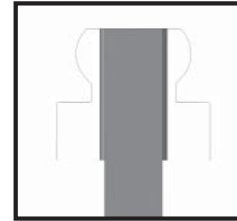
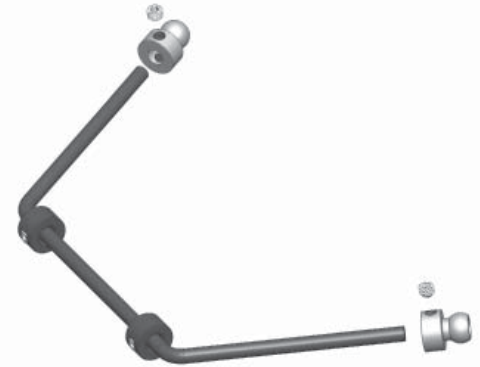
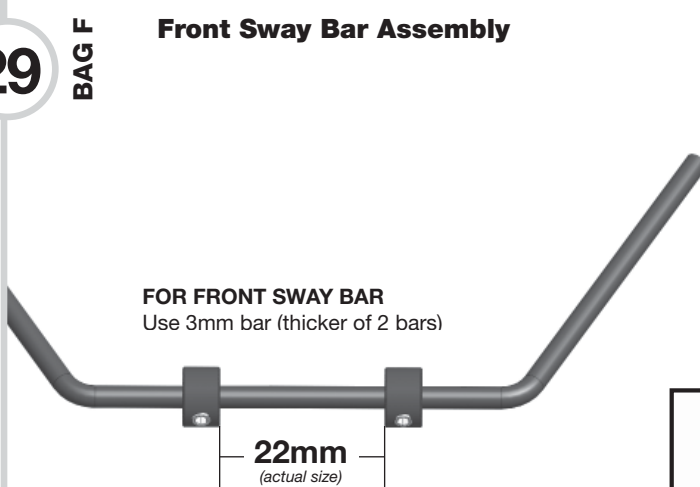

! IMPORTANT

Ensure the end of the sway bar is flush with the end of the pivot ball before securing it with set screw.

HARDWARE USED
(ACTUAL SIZE)

30

BAG F

Front Sway Bar & Skid Plate to Chassis

 x 1
M3 x 4 Set Screw

 x 2
M3 x 12 SHCS

 x 2
M4 x 22 SHCS

 x 2
M4 x 12 FHCS

! IMPORTANT

Use set screw to eliminate play in the sway bar, but ensure sway bar still rotates freely.

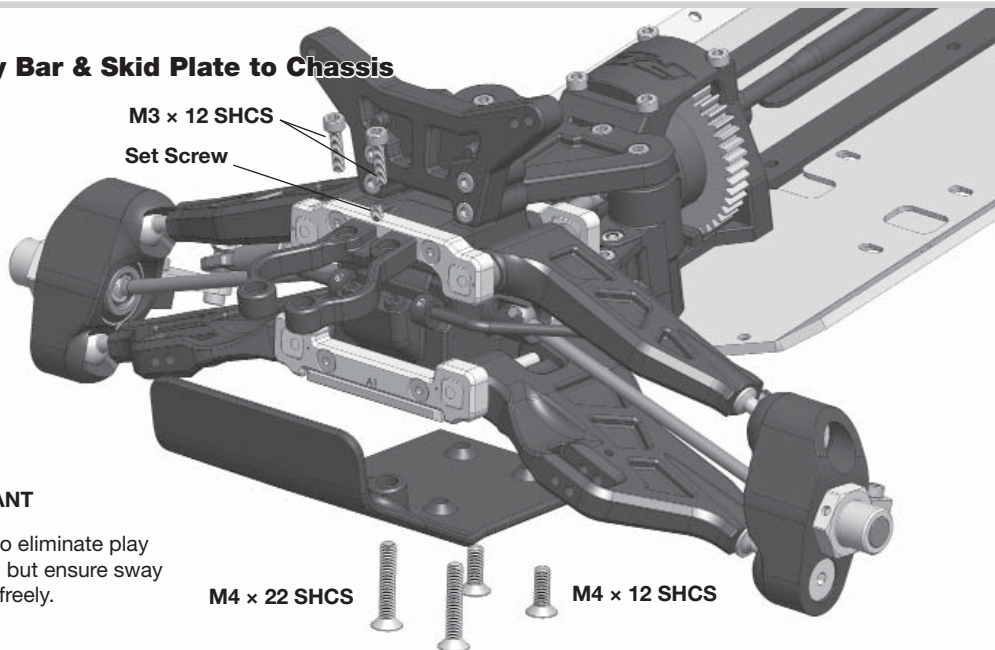

HARDWARE USED
(ACTUAL SIZE)

31

BAG F

Front Sway Bar to Arms

 x 2
Sway Bar Ball Stud

 x 2
Short Sway Bar Link

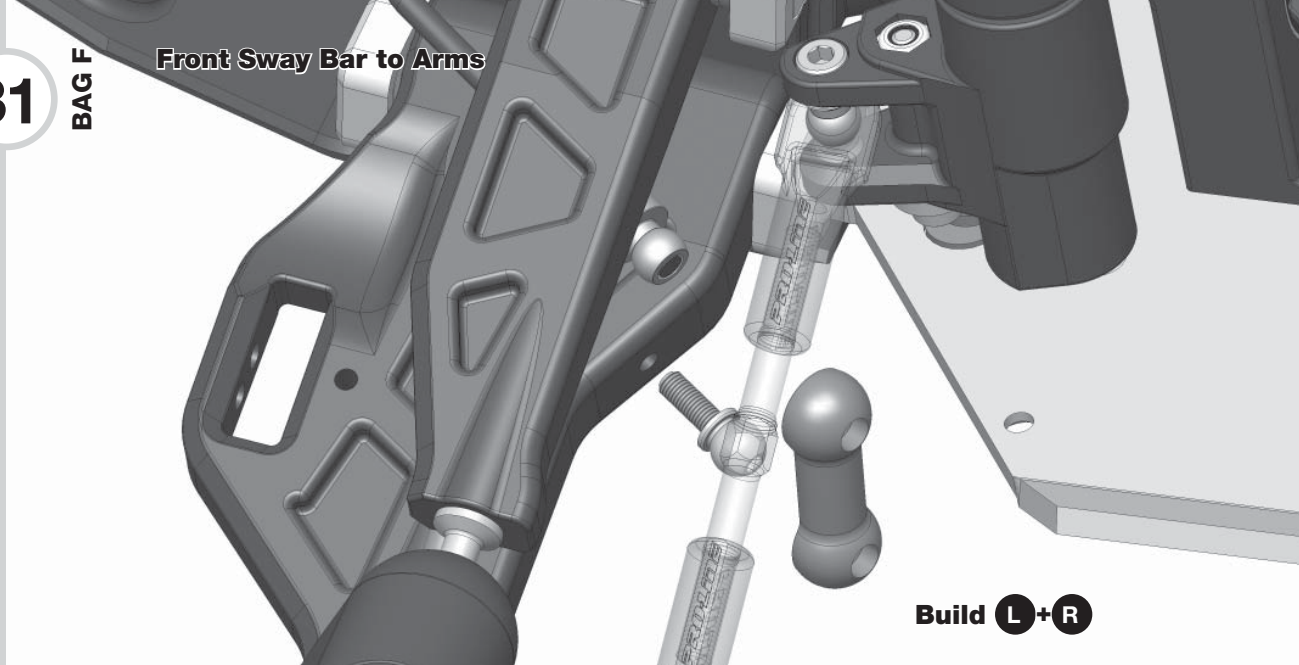

Build **L+R**

HARDWARE USED
(ACTUAL SIZE)

32

BAG F

Front Bumper Assembly

 x 2
M3 x 8 SHCS

 x 2
M3 x 12 SHCS

 x 2
M3 x 12 SHCS

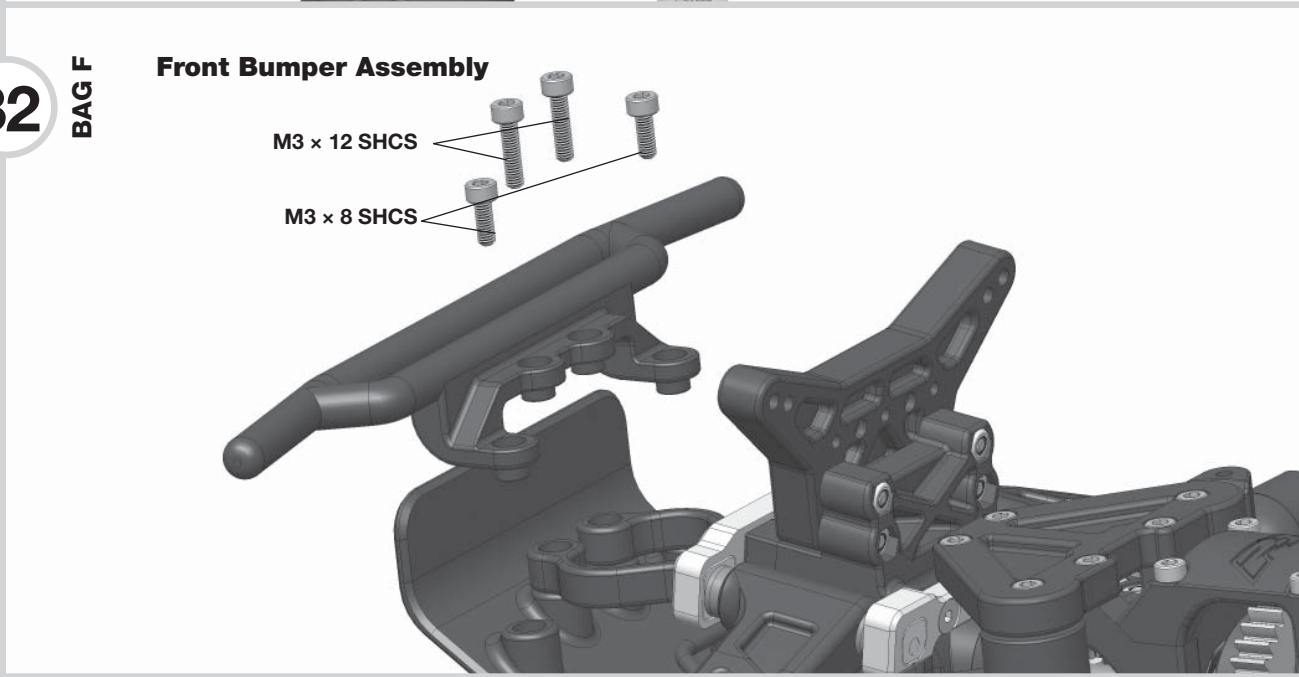

HARDWARE USED
(ACTUAL SIZE)

33

BAG G

Shock Assembly - Build 2x Front & 2x Rear

 x 4
M2.5 Locknut

 **FOR FRONT SHOCKS**
Use 6 x 1.4 pistons

 **FOR REAR SHOCKS**
Use 6 x 1.6 pistons

 x 4
Piston Washer

 x 4
10 x 1 O-Ring

 x 4
Upper Shaft Guide

 x 4
X-Ring

 x 4
Lower Shaft Guide

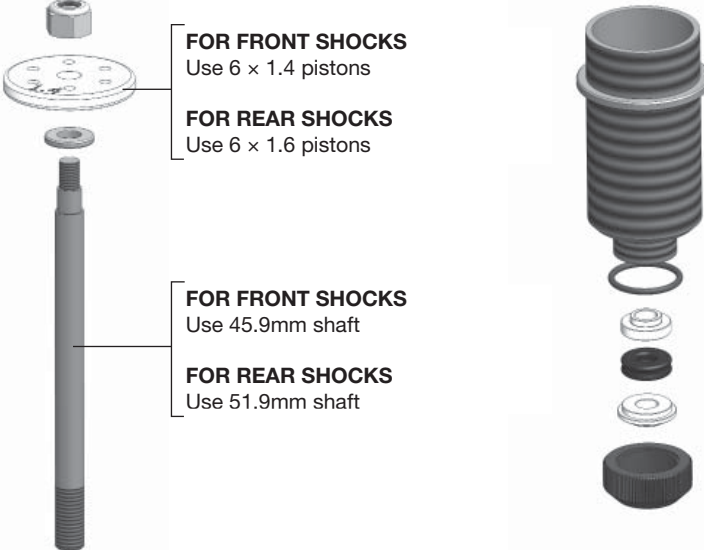

FOR FRONT SHOCKS
Use 38.5mm body

FOR REAR SHOCKS
Use 44.5mm body

FOR FRONT SHOCKS
Use 45.9mm shaft

FOR REAR SHOCKS
Use 51.9mm shaft

HARDWARE USED
(ACTUAL SIZE)

34

BAG G

Shock Assembly - Build 2x Front & 2x Rear



Lower Shock Pivot Ball x 4



PRO TIP
To avoid damage to the X-ring, apply a small amount of shock oil on the shaft before carefully feeding it through the shock body.

PRO TIP
To avoid damaging the shock shaft when threading the bottom shock eyelet on, use shock pliers (not included) **OR** use a 5mm nut driver (not included) to hold the 2.5mm locknut on top of piston.

35

BAG G

Shock Assembly - Build 2x Front & 2x Rear

1. With shock shaft fully extended, fill shock to within 2mm of top.
2. Slowly move shaft up and down to remove air from under the piston.
3. Wait for bubbles to come to the surface.
4. Place shock bladder into shock cap.
5. With shock shaft fully compressed and held in place, thread cap onto shock body slowly, letting excess oil escape.
6. Tighten shock cap completely and wipe away excess oil.
7. Install shock collar, spring, and spring retainer.

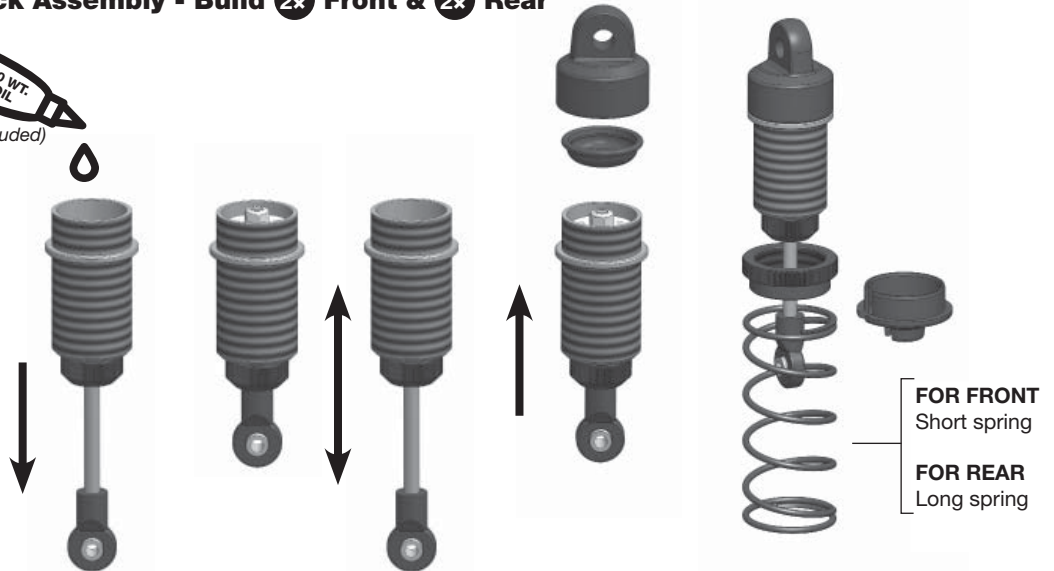
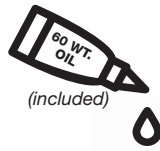

HARDWARE USED
(ACTUAL SIZE)

36

BAG G

Shock Assembly - Build 2x Rear & 2x Front



M3 X 30 SHCS x 4



M3 Washer x 4



M3 Locknut x 4



Lower Shock Pin x 4



M3 x 10 Set Screw x 4

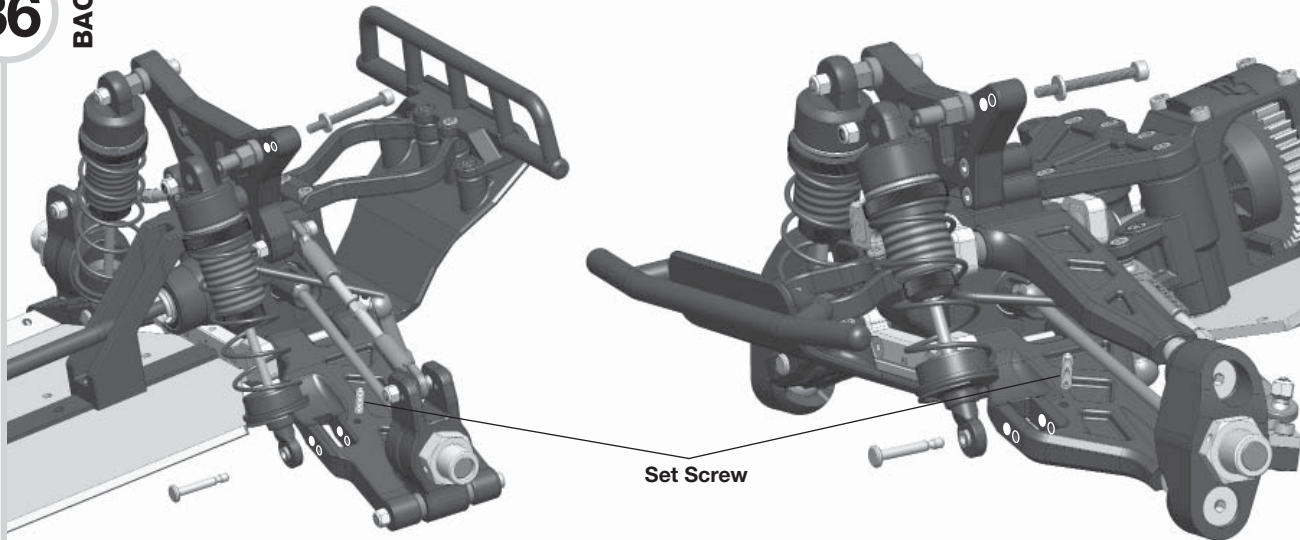

HARDWARE USED
(ACTUAL SIZE)

37

BAG H

Body Mount Assembly

 x 4
M4 x 16 Set screw

 x 4
6.5 x 1.5 O-Ring

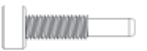
 x 4
Modified M3 x 14 SHCS

Build 4x



! IMPORTANT
Install Set Screw leaving 1/2 of the threads exposed.

PRO TIP
Your body mount hole position will depend on which style of body & tires you select. Set the body height so that the bottom sides of the body are as close to flush with bottom of the chassis as possible, while still taking into account tire clearances to avoid rubbing.

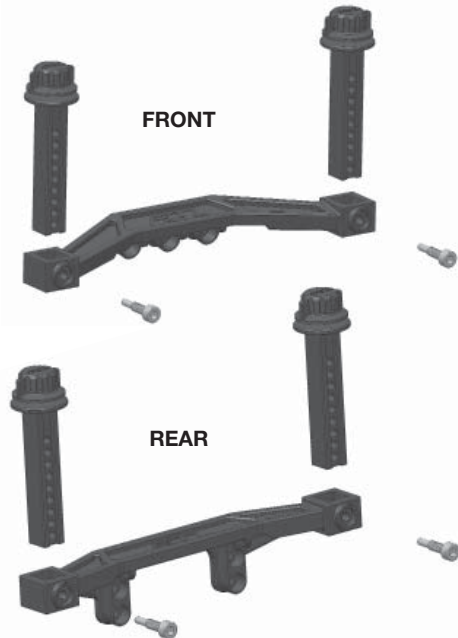

HARDWARE USED
(ACTUAL SIZE)

38

BAG H

Body Mounts to Chassis

 x 7
M3 x 10 SHCS

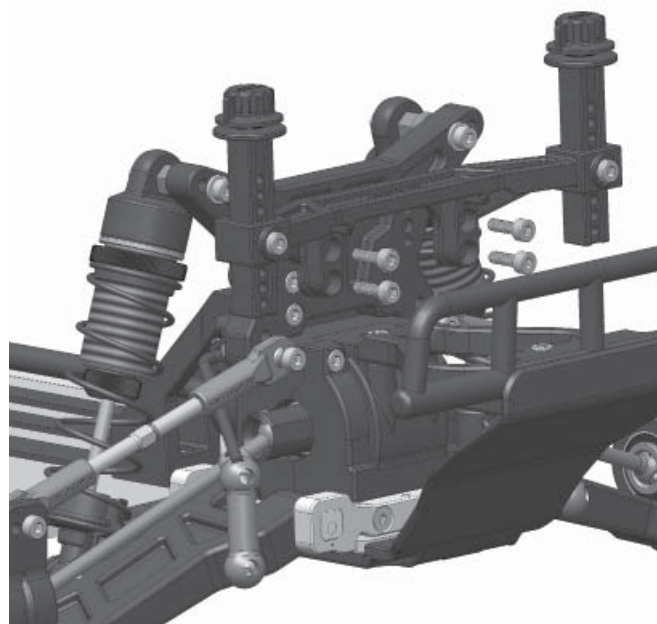
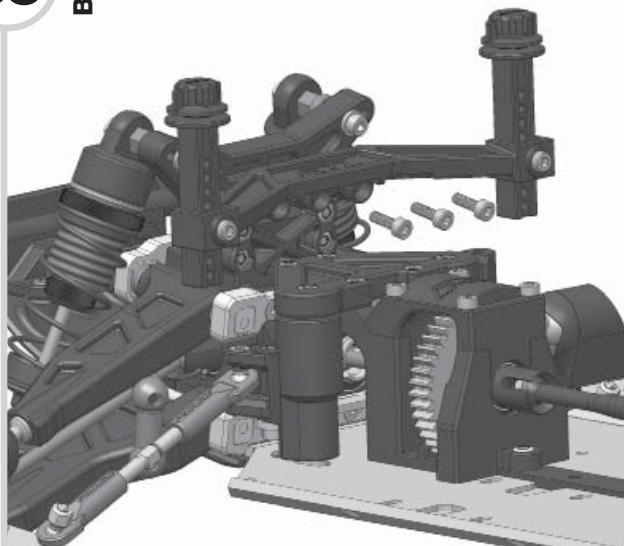

HARDWARE USED
(ACTUAL SIZE)

39

BAG H

Battery Strap Assembly

Build 2x

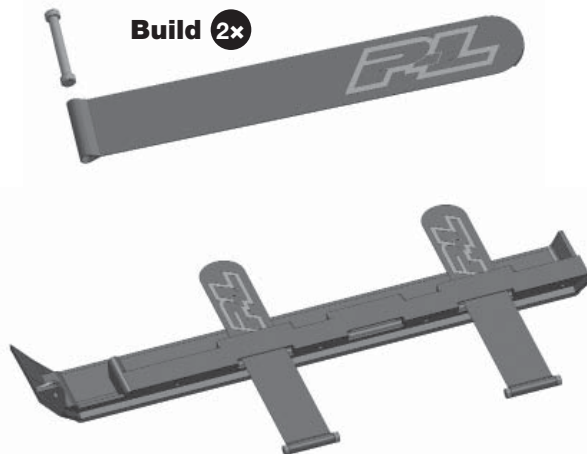

Build 2x

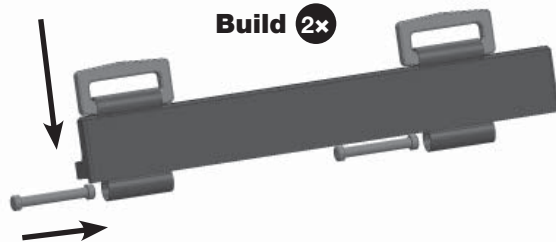



HARDWARE USED
(ACTUAL SIZE)

40

BAG H

Center Battery Strap Brace to Chassis

-  x 3
M3 Locknut
-  x 3
M3 x 10 FHCS

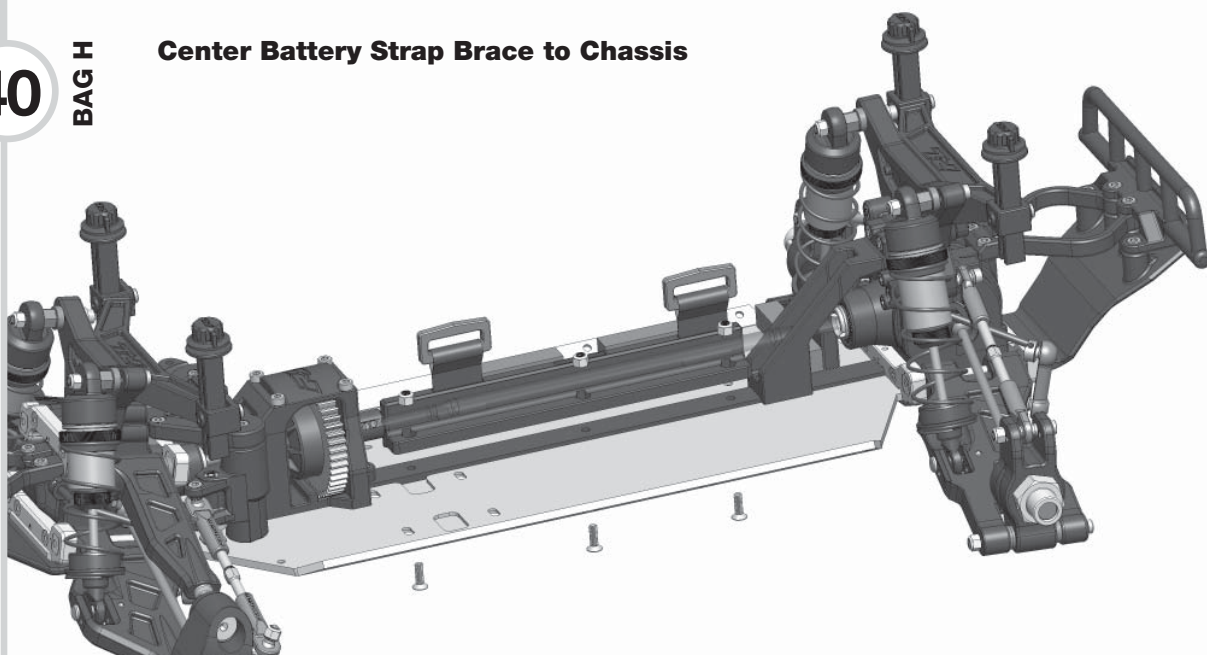

HARDWARE USED
(ACTUAL SIZE)

41

BAG H

Battery Stops

-  x 4
M3 x 10 FHCS

PRO TIP
The PRO-Fusion SC 4x4 accepts many battery sizes. Stock position for the battery is middle, but the battery can be shifted forward or rearward by moving the battery stops & straps. Place your battery in position and add the adhesive foam strips to pad it in each direction as needed. (see right)

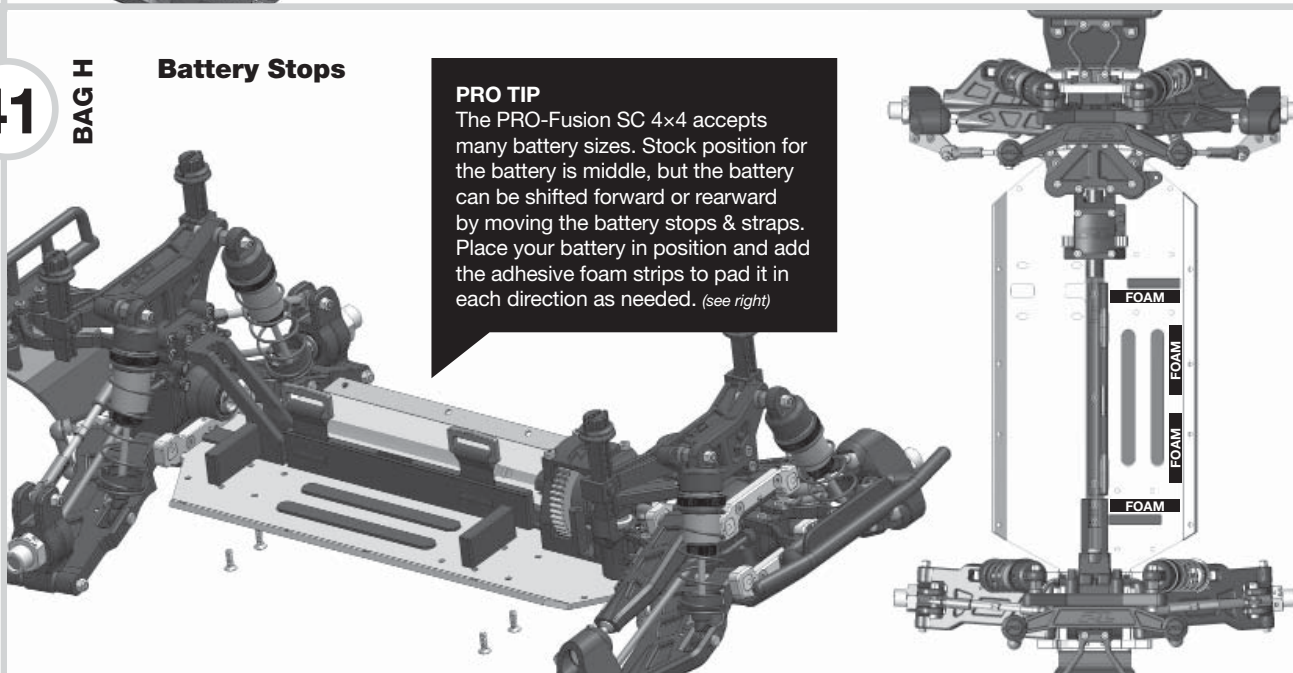



HARDWARE USED
(ACTUAL SIZE)

42

BAG H

Right Side Pod to Chassis & Servo Mount Assembly

-  x 5
M3 x 10 FHCS
-  x 2
M3 x 10 SHCS
-  x 2
M3 Washer

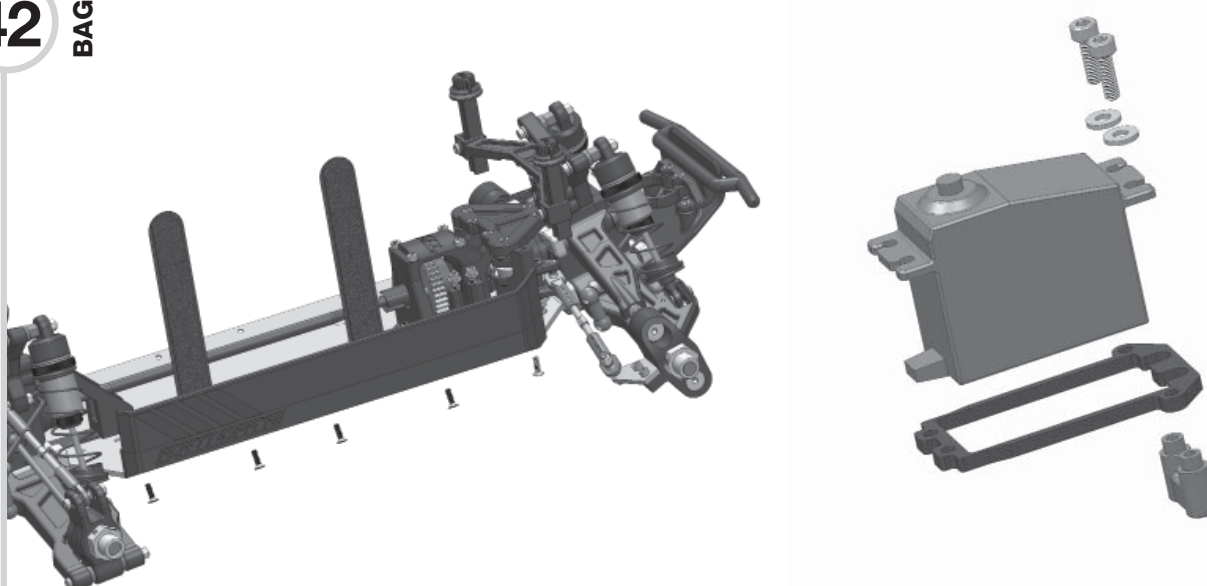

HARDWARE USED
(ACTUAL SIZE)

43

BAG H

Install Servo

 x 4
M3 x 10 SHCS

 x 2
M3 Washer

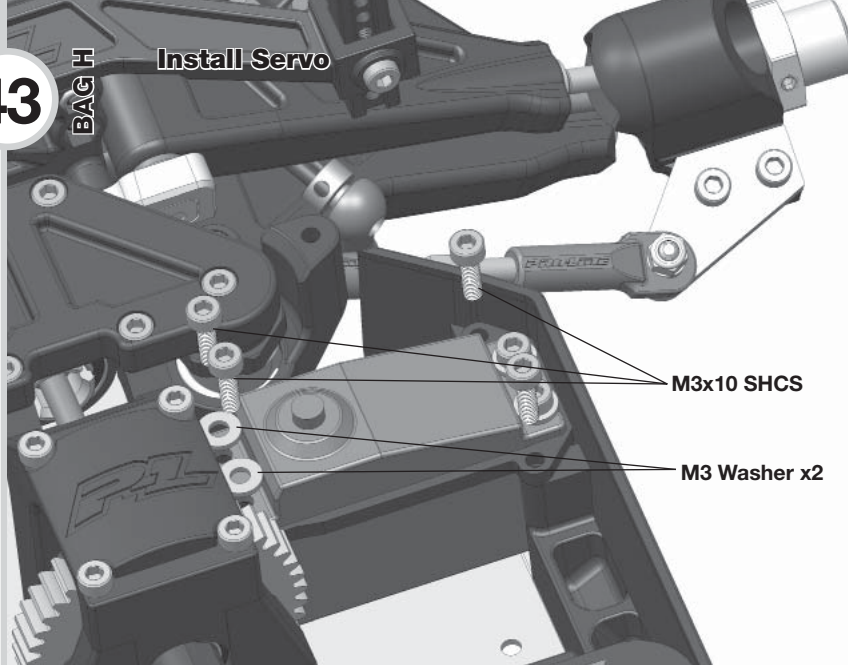

! IMPORTANT

Feed servo wire through channel in center diff case. Secure the wire to keep it from getting damaged by spur gear.

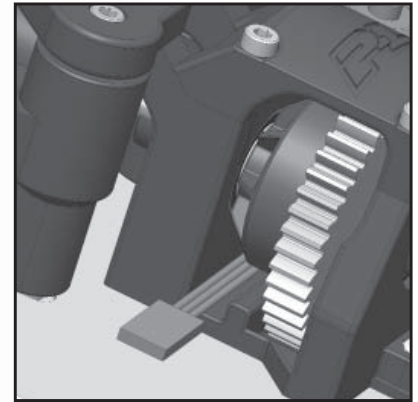

HARDWARE USED
(ACTUAL SIZE)

44

BAG H

Servo Horn & Steering Link Assembly

 x 2
M3 Locknut

 x 2
Steering Pivot Balls

 x 2
M3 x 16 SHCS

 x 1
M3 x 10 SHCS



1. Select the servo horn that matches the spline count on your servo.
23: Airtronics, JR, KO
24: Hitec
25: Futaba, Savox, ProTek
2. With radio and vehicle powered on and servo at neutral, install servo horn parallel to the connecting arm when tires are straight.
3. Secure servo horn with your stock servo screw, or included M3 x 10 SHCS

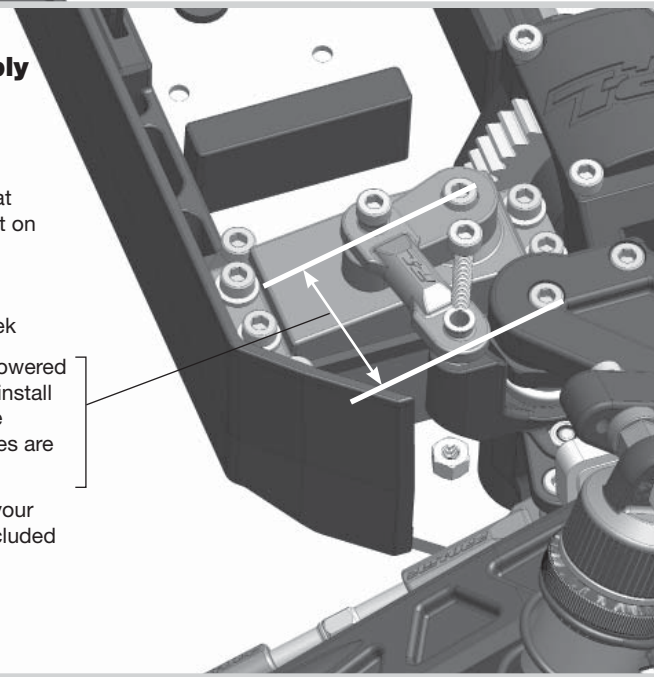



HARDWARE USED
(ACTUAL SIZE)

45

BAG I

Motor Mount

For 550 Motor
 x 2
M3 x 5 FHCS

 x 2
M3 x 10 FHCS

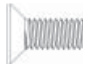
For 1:8 Motor
 x 2
M4 x 10 FHCS



PRO TIP
The PRO-Fusion SC 4x4 accepts 1:8 or 550 size motors. If using a 550 size motor, attach the included plastic motor support to the motor mount before installing motor.

FOR 550 MOTORS
Use (2) M3 x 10 FHCS and pinion reducer sleeve

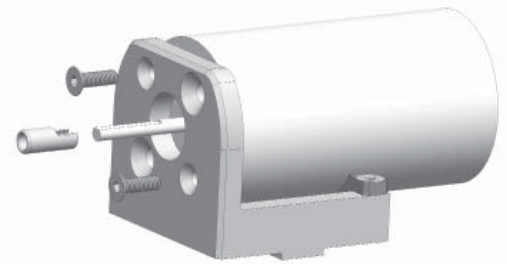

FOR 1:8 MOTORS
Use (2) M4 x 10 FHCS

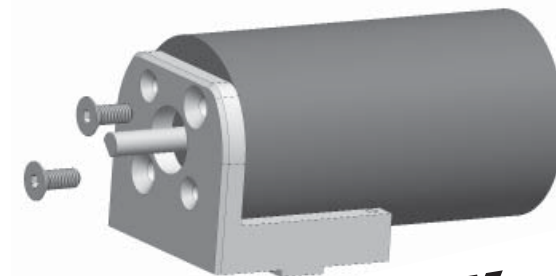

HARDWARE USED
(ACTUAL SIZE)

46

BAG 1

Install Motor & Pinion Gear

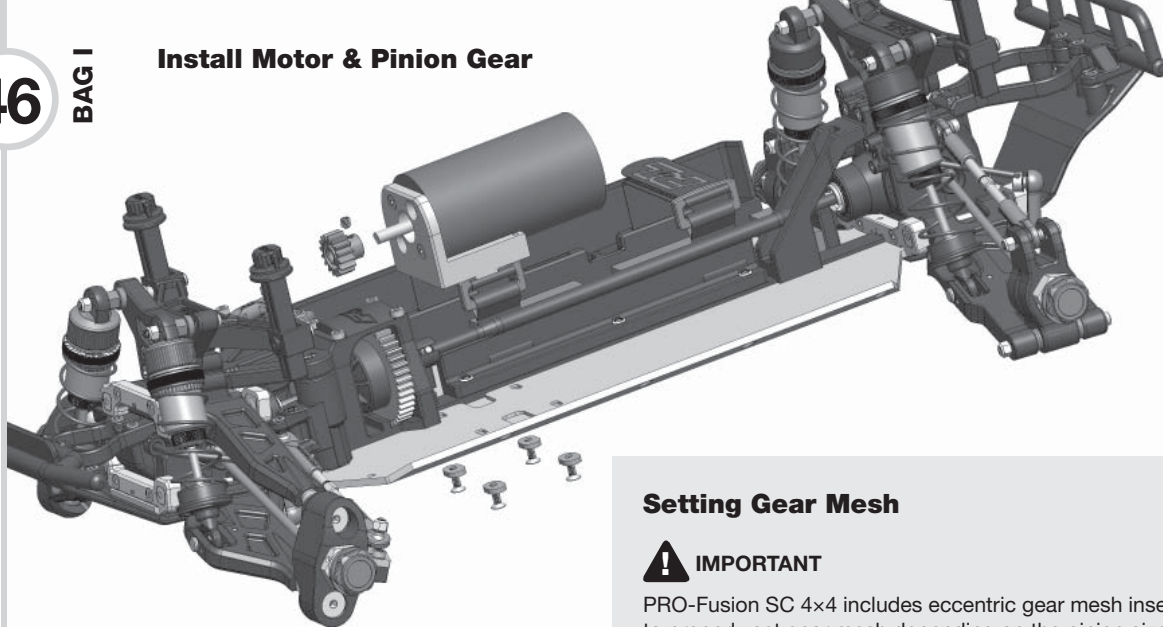

 × 1
M4 × 4 Set screw

 × 4
M3 × 10 FHCS

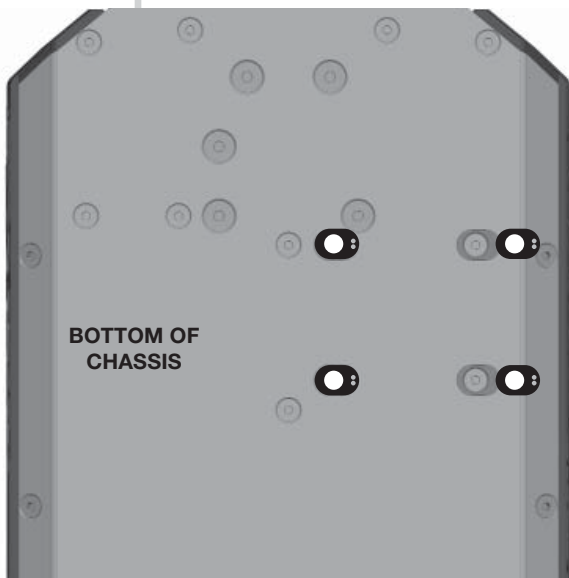

↑
FRONT OF VEHICLE

Setting Gear Mesh

! IMPORTANT









PRO-Fusion SC 4x4 includes eccentric gear mesh inserts to properly set gear mesh depending on the pinion size you select. See the chart below to set the correct orientation when attaching your motor mount to the chassis. It is recommended to use thread lock to secure the motor mount.

! IMPORTANT

Only use MOD1 pinion gears

! NOTE ORIENTATION

All four inserts must have the same orientation.

 = 14T	 = 21T
 = 15T	 = 20T
 = 16T <small>STOCK SETTING FOR PINION INCLUDED</small>	 = 19T
 = 17T	 = 18T

HARDWARE USED
(ACTUAL SIZE)

47

BAG 1

Install Electronics & Left Side Pod

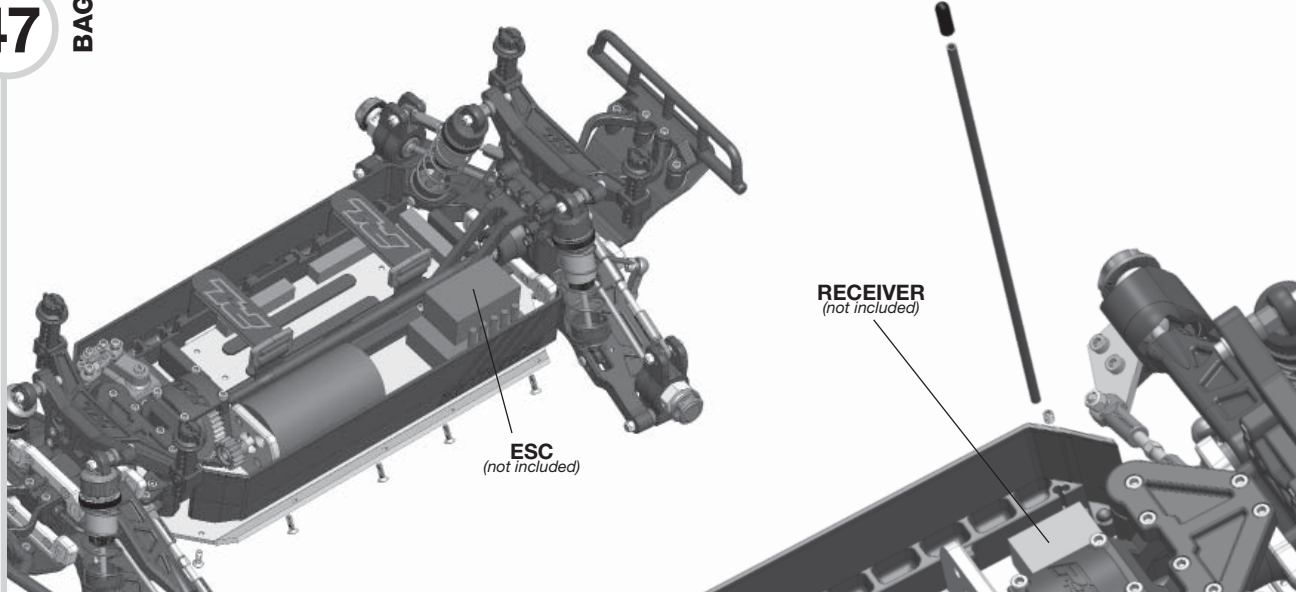

 × 5
M3 × 10 FHCS

 × 1
M3 × 4 Set Screw

Now the fun really begins! The PRO-Fusion SC 4x4 is able to use many different body and tire combinations. Make your truck into a True-Scale Short Course truck, an ultimate bashing machine, a slammed street truck — the possibilities are endless!

Visit prolinerracing.com/pro-fusion-sc4x4 to see the full lineup of options from Pro-Line Racing.

! IMPORTANT

Whichever body or tire style you choose, please note that the PRO-Fusion SC 4x4 only accepts 17mm hex sized wheels.

1. Before cutting or making holes in the body (*if the body is not pre-cut*), put the unpainted body on the chassis to mark mounting position and locations for the body post holes.
2. Before painting, wash the inside of the body with mild detergent such as dish soap, then rinse and dry thoroughly.
3. Apply window masks to inside of body, as well as any masks for painting your design. For painting tips, visit prolinerracing.com/how-to-tips
4. Use only polycarbonate-safe paint.
5. Allow paint to dry completely.
6. Remove window masks and outer film.
7. Apply decals.
8. Mount body to chassis using Secure-Loc Caps.



HARDWARE USED
(ACTUAL SIZE)



x 4

17mm Wheel Nuts

49

BAG 1

Install Tires

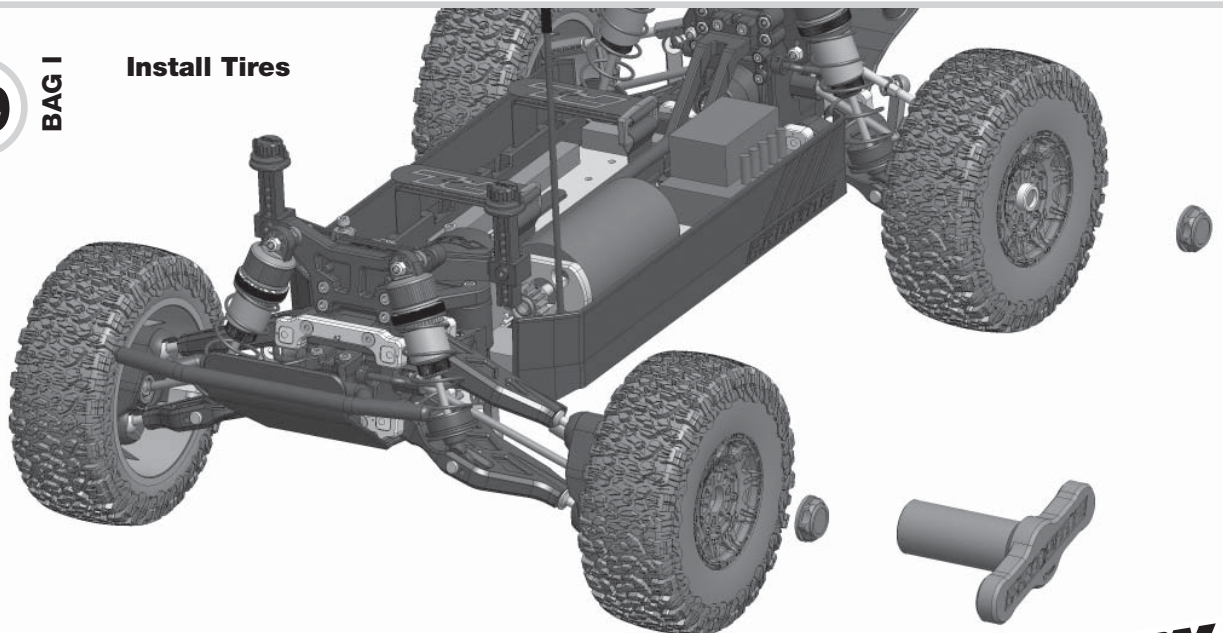

**PRO-FUSION
SC 4x4**

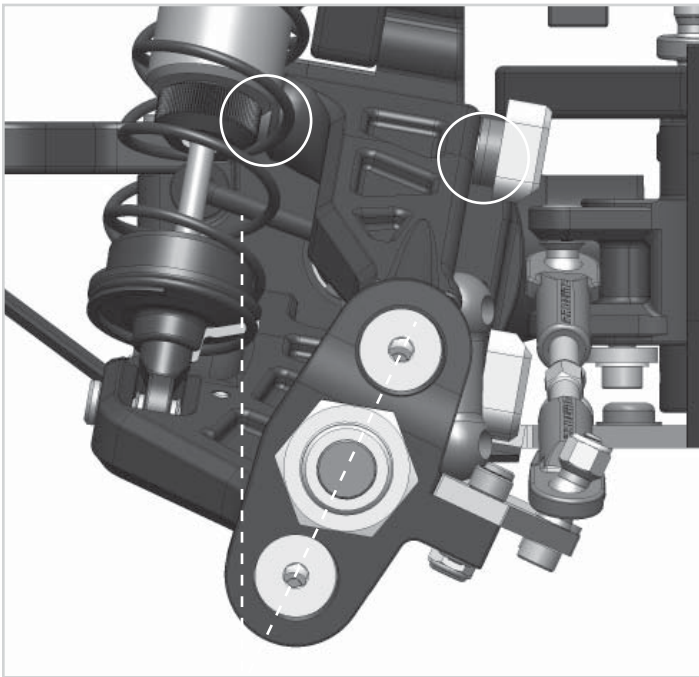

FRONT CASTER

This is the angle of the front hub from vertical when viewed from the side of the PRO-Fusion SC 4x4. It is adjusted by swapping or changing the combination of the 1mm and 2mm spacers on the front upper hinge pin. (see circled items above)

The PRO-Fusion SC 4x4 has 10° of front kick-up with adjustable front caster angle from +10° to +20°. The stock setting is +15° of caster.

Less caster angle typically provides more aggressive steering and does not handle bumps as well. More caster angle is easier to drive and handles bumps better.

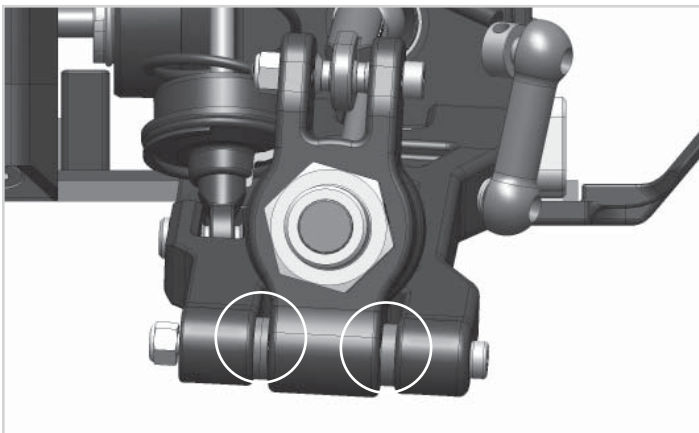

WHEELBASE

The wheelbase on the PRO-Fusion SC 4x4 is adjustable up to 4mm by moving the spacers next to the rear hub carriers. The stock setting is in the middle. A longer wheelbase is typically more stable, while a shorter wheelbase will turn sharper.

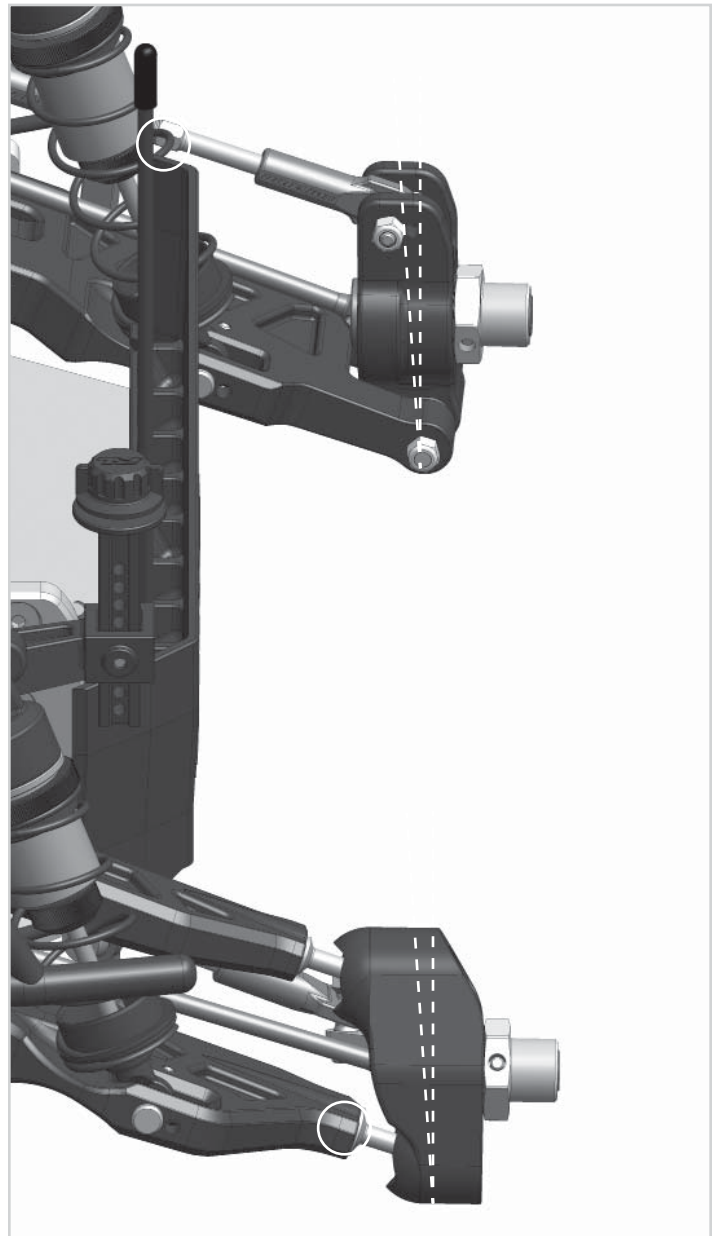

CAMBER

This is the angle of the tires as they lean in towards the center of the vehicle.

The front camber angle is adjustable by using the included 0.75mm spacers under the lower pivot balls. Each spacer increases camber by 2°.

The rear camber link turnbuckles are adjustable just like many race vehicles. Shortening this turnbuckle will increase camber.

Increased front camber will increase steering. Increased camber overall generally provides more traction and stability while cornering.

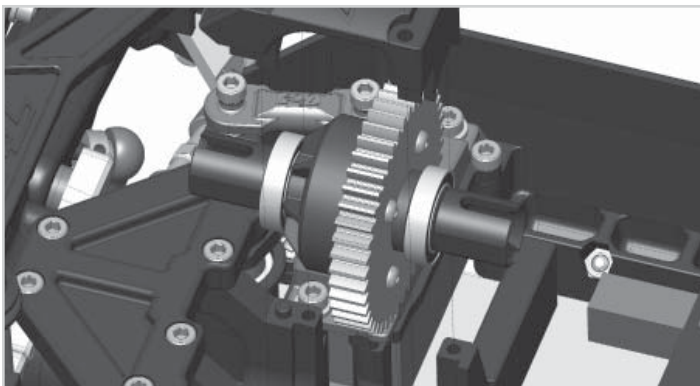

CENTER DIFFERENTIAL

Stock oil included in the center diff is 500,000 cSt.

When using 1:8 motor systems with 4S Lipo power, you may find that the center diff is sending too much power to the front wheels when the truck wheelies. To provide more balanced wheel speed front to rear with extreme power systems, use heavier diff fluid in the center diff.

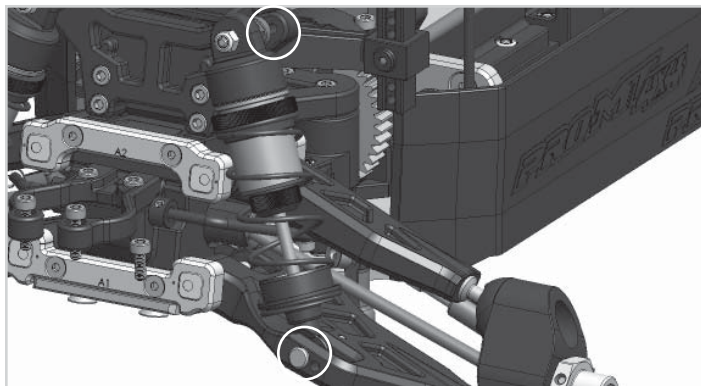

SHOCK OIL & LOCATION

Stock shock oil for the PRO-Fusion SC 4x4 is 60wt. There are two shock mounting locations on the shock towers and two on the lower arms.

The stock locations are on the inside holes, front and rear. This provides a smooth steering response and helps absorb bumps in rough terrain. The outer holes on the tower and arm provide a stiffer, more direct feel, while the outside hole on the arm also limits downtravel.

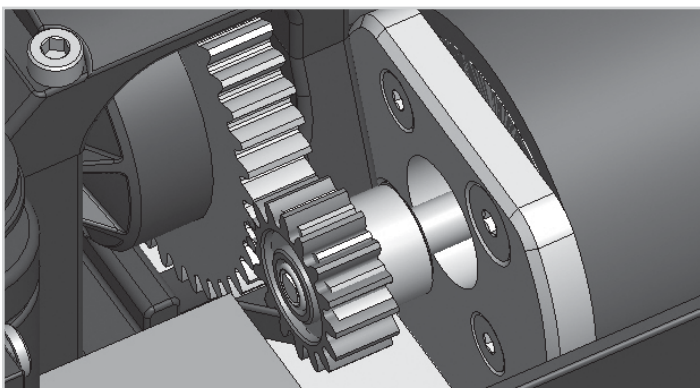

MOTOR & GEAR RATIOS

The Internal Gear Ratio of the PRO-Fusion SC 4x4 is 4:1 and the included Mod 1 Spur Gear is 44T.

A 16T Mod 1 Pinion Gear is included as a good starting point for most applications. If using a less powerful 550 motor, using a smaller pinion gear might be necessary to prevent the motor system from overheating.

When using high powered 1:8 Motor Systems and 4S Lipo power, Pro-Line testing has found motors in the 1900 kV range to be best for using the full range of Gear Ratios available (14T to 21T).

Larger pinion sizes typically provide higher top speeds but reduced bottom end power, while smaller pinion sizes are opposite. When using higher kV 1:8 motors with 4S Lipo power, start with the smallest pinion gear to prevent the motor system from overheating. If the battery is extremely hot, and/or the motor is so hot that you cannot touch it, use a smaller pinion gear.

Pinion Size	14	15	16	17	18	19	20	21
Final Gear Ratio	12.6	11.7	11.0	10.4	9.8	9.3	8.8	8.4
Rollout (Inches per motor revolution)	1.30	1.40	1.49	1.58	1.67	1.77	1.86	1.95

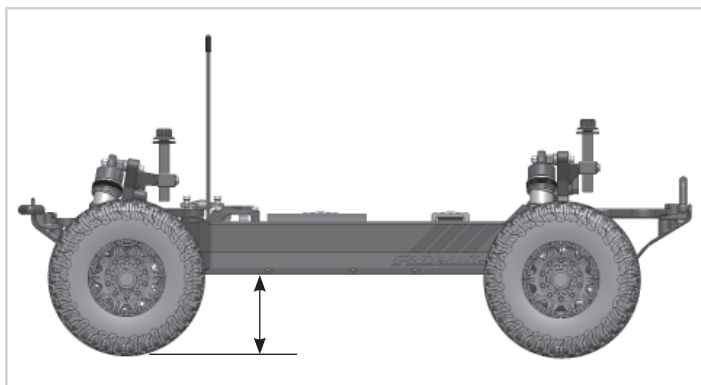

RIDE HEIGHT

This is the height of the chassis in relation to the surface. It is an adjustment that affects the way your PRO-Fusion SC 4x4 turns and goes through bumps.

To check the ride height, drop your vehicle with tires fastened from about a 5-6 inch height onto a flat surface. Once it settles into a position, check the height of each end of the vehicle in relationship to the surface. To raise the ride height, lower the shock collar on the shock evenly. To lower the ride height, raise the shock collar. Both left and right collars should be adjusted evenly.

Short Course Tires



TRENCHER X SC

Award-winning all-terrain tire works on any surface.

#1190-24
Premounted on Raid 17mm hex wheels



STREET FIGHTER SC

Perfect balance of G-force enhancement and style.

#1167-24
Premounted on Raid 17mm hex wheels



BLOCKADE SC

The Blockade excels in a wide variety of track conditions.

#1183-24
Premounted on Raid 17mm hex wheels



RAID

17mm hexes are stronger and can handle more power.

#2770-03
2.2"/3.0" Black Wheels



F-11

2.8" tough and rugged look with 17mm Hex for Extreme Bashing.

#2755-03
2.8" (Traxxas Style Bead) Black Wheels

2.8" MT Tires



SAND PAW 2.8"

A must for sand and snow conditions to throw up huge roosts.

#1186-18
Premounted on F-11 17mm hex wheels



PRIME 2.8"

The best option for street or for speed runs.

#10116-18
Premounted on F-11 17mm hex wheels



TRENCHER 2.8"

Award-winning all-terrain tire works on any surface.

#1170-18
Premounted on F-11 17mm hex wheels



BADLANDS MX28 2.8"

Big, bold, motocross-inspired for traction on any surface.

#10125-18
Premounted on F-11 17mm hex wheels



ROAD RAGE 2.8"

Low-profile for slammed street-truck styling.

#1172-18
Premounted on F-11 17mm hex wheels

Upgrade Parts

Aluminum shock caps	6318-00
Aluminum shock mounts	6318-01
Steel spur gear	6318-02
Aluminum servo saver	6318-03
7075 Aluminum A1 Hinge Pin Holder	6332-01
7075 Aluminum A2 Hinge Pin Holder	6332-02
7075 Aluminum B1 Hinge Pin Holder	6332-03
7075 Aluminum B2 Hinge Pin Holder	6332-04
7075 Aluminum C Hinge Pin Holder	6332-05
7075 Aluminum D Hinge Pin Holder	6332-06
Extended Front & Rear Body Posts	6070-00

Bodies for SC Tires

Volkswagen® Baja Bug Clear Body	3238-62
Volkswagen® Full Fender Baja Bug Clear Body	3238-63
Chevy® Silverado™ 1500 Clear Body	3307-60
Flo-Tek Clear Body	3355-00
Toyota Tundra Clear Body	3364-00
1966 Ford® F-100 Clear Body	3408-00
EVO SC Clear Body	3413-00
2013 Ram 1500 True Scale Clear Body	3420-00
1981 Ford® Bronco Clear Body	3423-00
Ram 2500 Clear Body	3441-00
Pre-Cut Flo-Tek Fusion Clear Body	3458-17
2017 Ford® F-150 Raptor True Scale Clear Body	3461-00
Toyota Tundra TRD Pro True Scale Clear Body	3476-00
2017 Ford® F-150 Raptor Desert Truck Clear Body	3489-00
1978 Chevy® C-10™ Race Truck Clear Body	3510-00
2019 Chevy® Silverado™ True Scale Clear Body	3512-00

Bodies for 2.8" MT Tires

Chevy® Silverado™ Pro-Touring Clear Body	3457-00
Pre-Cut Monster Fusion Clear Body	3498-17
1956 Ford® F-100 Pro-Touring Clear Body	3514-00

Part #	Part Name	Qty. in group
6062-06	50x4mm Steering Turnbuckle	2
6070-02	Secure-Loc Cap Kit	4
6082-02	60x4mm Rear Turnbuckle	2
6092-06	Diff Internal Gear Replacement Kit	1
6102-01	Replacement Rod End Set	1
6308-02	Shock Shaft Guides	8
10125-18	Badlands MX28 2.8" Tires Pre-mounted on F-11 17mm hex wheels	2
4005-01	44T Mod 1 Spur Gear	3
4005-02	Front Bumper Brace	1
	Front Bumper Skid	1
	Front Bumper	1
4005-03	Rear Bumper	1
	Rear Bumper Skid	1
	Rear Bumper Brace	1
4005-04	Rear Shock Tower	1
	Front Shock Tower	1
4005-05	Front Arm	2
	Front Upper Arm	2
4005-06	Rear Arm	2
4005-07	Pivot Ball	4
	Pivot Ball Set Screw	4
	Front Camber Spacer 0.75mm	6
	Piston 1.2mm 6 Hole (Front)	4
	Piston 1.4mm 6 Hole (Rear)	4
	Delrin Pivot Insert	4
4005-08	10T Mod 1 Bevel Gear	1
	Center Outdrive Clip	2
	40T Mod 1 Bevel Gear	1
4005-09	1mm Shims	8
	2mm Shims	6
	Sway Bar Collar	4
	Chassis Plug	2
	Chassis Plug Washer	2
	Hinge Pin Insert	12
4005-10	16T Mod 1 Pinion Gear	1
	M4 x 4 Set Screw	1
4005-11	Battery Strap Bar	4
	Battery Strap Hook & Loop	2
	Battery Strap D-Ring	2
4005-12	Axle	2
4005-13	Center Front Dog Bone	1
	Center Rear Dog Bone	1
4005-14	Outdrive	2
4005-15	Drive Shaft Dog Bone Front	2
4005-16	Drive Shaft Dog Bone Rear	2
4005-17	Front Shock Body	2
4005-18	Rear Shock Body	2

4005-19	Front Upper Hinge Pin	2
	Lower Inner Hinge Pin	4
	Rear Outer Hinge Pin	2
4005-20	Servo Saver Adjustment Nut	1
	Steering Post	2
	Steering Saver Hex Tube	1
	Servo Saver Spring	1
	Servo Saver O-Ring	1
4005-21	Sway Bar Pivot Ball	2
	Sway Bar Ball Stud	4
	M3 x 3 Set Screw	4
	Rear Sway Bar - 2.7mm	1
	Front Sway Bar - 3.0mm	1
4005-22	17mm Wheel Hex	2
	M4 x 16 Modified Set Screw	4
4005-23	CVD Drive Pin Cup	4
	CVD Drive Pin - Long	4
	M3 x 3 Set Screw	4
4005-24	Front Shock Spring	2
	Rear Shock Spring	2
4005-25	Motor Mount	1
	M3 x 10 FHCS	6
	M4 x 10 FHCS	2
	M3 x 5 FHCS	2
4005-26	Motor Mount Insert 14T & 21T	4
	Motor Mount Insert 15T & 20T	4
	Motor Mount Insert 16T & 19T	4
	Motor Mount Insert 17T & 18T	4
4005-27	Servo Mount	1
4005-28	B1 Inner Hinge Pin Holder w/ Insert 1	1
4005-29	A1 Inner Hinge Pin Holder w/ Insert 1	1
4005-30	D1 Inner Hinge Pin Holder w/ Insert 1	1
4005-31	C1 Inner Hinge Pin Holder w/ Insert 1	1
4005-32	A2 Inner Hinge Pin Holder w/ Insert 1	1
4005-33	B2 Inner Hinge Pin Holder w/ Insert 1	1
4005-35	Center Steering Linkage	1
	Battery Stop	2
	Center Battery Strap Brace	1
	Rear Sway Bar Bracket	2
	Servo Adapter	1
	Servo Arm Left	1
	Servo Arm Right	1
	Servo Saver	1
	Servo Horn - 23T	1
	Servo Horn - 24T	1
	Servo Horn - 25T	1
	3x6x2.5 Flanged Bearing	2

4005-36	M3 x 14 SHCS	4
	Rear Body Mount	1
	Front Body Mount	1
	Body Posts	4
	6.5 x 1.5 O-Ring	4
	M4 x 16 Set Screw	4
4005-37	16x8x5mm Bearing	2
	18x12x4mm Bearing	14
	11x5x4mm Bearing	4
4005-38	Diff Cap	1
	Diff Housing	1
	4.7 x 0.5 O-Ring	6
	8 x 1.5 O-Ring	6
	5.2x15x0.2 Large Diff Shim	6
	Diff Seal O-Ring	3
4005-39	17mm Wheel Nuts	4
4005-40	X-Ring	4
	10 x 1 O-Ring (Bottom Cap)	4
	Shock Diaphragm	4
4005-41	M2.5 Locknut	2
	Piston Washer	2
	Rear Shock Shaft	2
4005-42	M2.5 Locknut	2
	Piston Washer	2
	Front Shock Shaft	2
4005-43	Shock Bottom Cap	4
	Shock Cap & Collar	4
	Shock Rod End	4
	Shock Spring Retainer	4
	Shock Stand Off	4
	Steering Servo Link	1
	Sway Bar Link Rear (Long)	2
	Sway Bar Link Front (Short)	2
	Lower Shock Pivot Ball	4
	Lower Shock Pin	4
4005-44	Front Diff Case	1
	Front Diff Cover	1
	Rear Diff Case	1
	Rear Diff Cover	1
	Front Lower Case Cover	1
	Rear Lower Case Cover	1
4005-45	550 / 36mm Motor Support	1
	Center Diff Cover	1
	Center Diff Mount	1
	Top Plate	1
4005-47	Rear Hub Carrier	1

4005-48	Front Hub - Left	1
	Front Hub - Right	1
	Front Hub Steering Plate	2
4005-49	Rear Chassis Brace	1
	17mm Wheel Wrench	1
4005-50	Pinion Reducer	1
4006-01	Front Bumper / Center Brace	1
4006-02	SC Side Pods	1
4006-03	PRO-Fusion SC Chassis / Spine	1
4006-04	Center Rear Dog Bone	1
4006-05	17mm Rear Wheel Hex	2
M3 x 12 SHCS	Qty. in kit: 6	
M3 x 8 SHCS		6
Modified M3 x 14 SHCS		4
M3 Washer		8
M3 x 10 SHCS		26
M4 x 12 FHCS		9
M3 x 4 Set Screw		4
M3 x 14 FHCS		6
M4 x 22 FHCS		4
M3 x 22 SHCS		6
M2.5 x 10 SHCS		4
M3 x 30 SHCS		4
M3 x 10 Set Screw		4
M3 x 20 FHCS		4
M3 x 5 FHCS		4
M3 x 10 FHCS		33
M3 x 16 SHCS		16
M4 x 10 FHCS		2
Antenna Tube		1
Antenna Cap		1
M2.5 x 10 BHCS		12
M3 x 25 SHCS		4
M3 Locknut		38
M2.5 Locknut		4
M3 x 3 Set Screw		8
Diff Drive Pins		6

PROLINE

Pro-Line Racing
201 W. Lincoln St.
Banning, CA 92220
prolinerracing.com

1-800-899-RACE(7223) or (951) 849-9781

Technical Assistance:
support.prolinerracing.com



facebook.com/prolinerracing
@prolinerracing